



Experience
Pego Hardware
Sale Support

Head Office & Application Centre:

Pego Hardware
Plot No. 2B/1/B, Site IV,
Sahibabad Industrial Area,
Ghaziabad (U.P.) - 201010 (India)

Regional Office (Delhi)

Pego Hardware
4899, Hauz Qazi,
Delhi - 110006 (India)

Regional Office (Coimbatore)

Pego Hardware
No. 2/227F Erangattu Thottam, Rasiplyam,
Sulur, Coimbatore - 641402 (India)

For Sales

North: +91-8700941938 | West: +91-8929070625 | Andhra & Telangana: +91-8929070624
East: +91-9319623434 | Karnataka: +91-9999697660 | Tamilnadu: +91-8929070623
W. Bengal & Seven Sisters: +91-9311600435 | UP, UK, J&K: +91-9871485577
Maharashtra: +91-9311600436

Customer Support: +91-8929701016 | E-Mail: info@pego.in | www.pego.in

Pego
*Inspired by Design,
Powered by Quality*



ALUMINIUM DOORS & WINDOWS HARDWARE

Inspired By Design, Powered By Quality



ABOUT COMPANY

PEGO is one of the leading and a pioneer Door & Window Hardware Brand in India. PEGO has created niche with focus on Aluminium & uPVC Door & Window Hardware. "Inspired by Design & Powered by Quality" – The Organization lives by this Tagline & it is integral to the ethos of the company.

PEGO Hardware through its reach, diversity & innovations has made enormous strides in setting trends, benchmarks, redefining and creating strong niche in the Indian fenestration industry over a decade. The Company has already executed many Private, Government & Institutional Projects across the country.

PEGO has complete range of Aluminium & uPVC door & window hardware covering:

- Casement Door Hardware
- Sliding Door Hardware
- Casement Window Hardware
- Sliding Window Hardware

The USP of PEGO is its ability to address the need of the industry and various stakeholders with respect to hardware solutions through its range of innovative and premium products. It is for this reason company has enjoyed patronage over the years of Developers, Architects, Consultants & Door and Window Manufacturers.

PEGO with its extensive growth has managed its presence on PAN India basis through its sales team and Branch Offices cum Warehouses. The company boasts of state of the art facility with testing laboratory. At its head office, PEGO has created first of its kind Application Centre by a hardware company in fenestration Industry in India with the display of new innovative hardware products & their application. The Company has its In-House R&D Lab fully equipped to measure product cycle testing, powder coating thickness, material composition enabling it to deliver premium quality products with 10 years warranty. All products are backed up with all the requisite certifications from internal & external laboratories.

PEGO under the leadership of its founder Mr. Karan Shah – Foster the team with zeal, thrive and passion leading them to become the company to be "Partner of Choice...!" on a National Level.

TEST CERTIFICATES



SPECTRO Analytical Labs Limited
TEST REPORT

ZINC ALLOY

Date: 06-Aug-19 07:43 PM Program: Zn-80-X
Sample ID: ID-019080018-1 Comment: Zn Alloy

Element	%	Test Method
Zinc	26.77	SD17CHEL05-Zn
Aluminum	3.56	-do-
Copper	0.830	IS 2592:1983 (HA 2000)
Magnesium	0.007	SD17CHEL05-Zn
Cadmium	0.0002	-do-
Iron	0.010	IS 2592:1983 (HA 2000)
Indium	0.0001	SD17CHEL05-Zn
Nickel	0.0090	-do-
Lead	0.0074	-do-
Tin	0.0001	-do-
Thallium	0.0001	-do-

SPECTRO Analytical Labs Limited
TEST REPORT

STAINLESS STEEL

Date: 06-Aug-19 04:12 PM Program: Fe-30-X
Sample ID: ID-019080015-2 Comment: SSFe

Element	%	Specified	Conformity	Test Method
Carbon	0.044	0.050 Max	Yes	ASTM E-1099-2014
Silicon	0.375	0.750 Max	Yes	-do-
Manganese	1.15	2.00 Max	Yes	-do-
Sulfur	<0.005	0.010 Max	Yes	-do-
Phosphorus	0.0210	0.030 Max	Yes	-do-
Chromium	18.21	18 Min - 22.00 Max	Yes	-do-
Nickel	8.68	8 Min - 10.50 Max	Yes	-do-
Nitrogen	0.045	0.100 Max	Yes	SOPCHE03-05

Remark: Sample Conforms to Grade A304M with respect to above test.

SPECTRO Analytical Labs Limited
TEST REPORT

ALUMINUM ALLOY

Date: 06-Aug-19 07:48 PM Program: Al-10-X
Sample ID: ID-019080016-4 Comment: Al Alloy

Element	%	Test Method
Copper	0.020	ASTM E1251-2011
Magnesium	0.250	-do-
Silicon	0.54	-do-
Iron	0.050	SOPCHE00-AL
Nickel	0.019	ASTM E1251-2011
Manganese	0.074	-do-
Zinc	0.448	-do-
Lead	0.024	SOPCHE00-AL
Tin	0.012	-do-
Titanium	0.022	ASTM E1251-2011
Chromium	0.016	-do-
Vanadium	0.011	-do-

SPECTRO Analytical Labs Limited
SALT SPRAY TEST REPORT

TEST RESULTS

Material	120 / 144 Hours	240 Hours	480 Hours	720 Hours	960 Hours	1200 Hours	1440 Hours	1680 Hours	1920 Hours	2160 Hours	2400 Hours
1	Pass	Pass	Pass	Pass	Pass	Pass	Pass	Pass	Pass	Pass	Pass
2	Pass	Pass	Pass	Pass	Pass	Pass	Pass	Pass	Pass	Pass	Pass
3	Pass	Pass	Pass	Pass	Pass	Pass	Pass	Pass	Pass	Pass	Pass
4	Pass	Pass	Pass	Pass	Pass	Pass	Pass	Pass	Pass	Pass	Pass
5	Pass	Pass	Pass	Pass	Pass	Pass	Pass	Pass	Pass	Pass	Pass
6	Pass	Pass	Pass	Pass	Pass	Pass	Pass	Pass	Pass	Pass	Pass
7	Pass	Pass	Pass	Pass	Pass	Pass	Pass	Pass	Pass	Pass	Pass
8	Pass	Pass	Pass	Pass	Pass	Pass	Pass	Pass	Pass	Pass	Pass
9	Pass	Pass	Pass	Pass	Pass	Pass	Pass	Pass	Pass	Pass	Pass
10	Pass	Pass	Pass	Pass	Pass	Pass	Pass	Pass	Pass	Pass	Pass
11	Pass	Pass	Pass	Pass	Pass	Pass	Pass	Pass	Pass	Pass	Pass
12	Pass	Pass	Pass	Pass	Pass	Pass	Pass	Pass	Pass	Pass	Pass
13	Pass	Pass	Pass	Pass	Pass	Pass	Pass	Pass	Pass	Pass	Pass
14	Pass	Pass	Pass	Pass	Pass	Pass	Pass	Pass	Pass	Pass	Pass
15	Pass	Pass	Pass	Pass	Pass	Pass	Pass	Pass	Pass	Pass	Pass
16	Pass	Pass	Pass	Pass	Pass	Pass	Pass	Pass	Pass	Pass	Pass
17	Pass	Pass	Pass	Pass	Pass	Pass	Pass	Pass	Pass	Pass	Pass
18	Pass	Pass	Pass	Pass	Pass	Pass	Pass	Pass	Pass	Pass	Pass

TEST RESULTS: 120 / 144 Hours: 100% Pass, 240 Hours: 100% Pass, 480 Hours: 100% Pass, 720 Hours: 100% Pass, 960 Hours: 100% Pass, 1200 Hours: 100% Pass, 1440 Hours: 100% Pass, 1680 Hours: 100% Pass, 1920 Hours: 100% Pass, 2160 Hours: 100% Pass, 2400 Hours: 100% Pass.

SPECTRO Analytical Labs Limited
TEST REPORT

Thickness of Coating

ID No- 019080018-4

S. N.	Test Parameter	Result	Test Method
1.	Thickness of Powder Coating	90 - 95 micron	IS 8012-1982 (RA-0215)

SPECTRO Analytical Labs Limited
TEST REPORT

Thickness of Coating

ID-019080008-3

S. N.	Test Parameter	Result	Test Method
1.	Thickness of Zinc Coating	14.5 micron	IS 1373-1988

1. SYSTEM HARDWARE CONFIGURATION 6-16
2. CORNER CLEATS 7-21
3. COCKSPUR HANDLES 22-23
4. FRICTION STAYS 24-27
5. TRANSMISSION SYSTEMS 28-32
6. STRIKERS 33-38
7. SHOOTBOLTS 39
7. CREMONE HANDLES 40-43
8. SPINDLE TRANSMISSION HANDLES 44-46
9. LOCKABLE HANDLES 47-49
10. CONCEALED SLIDING LOCKS 50-53
11. SLIDING PREMIUM HANDLES 54-57
12. SLIDING ROLLERS 58-65
13. CASEMENT LOCK BODY 66-68
14. SYSTEM HARDWARE 69-71
15. CASEMENT DOOR HANDLES 72-74
16. BUMP STOPPER 75
17. HINGES 76-78
18. PLASTIC ACCESSORIES 79

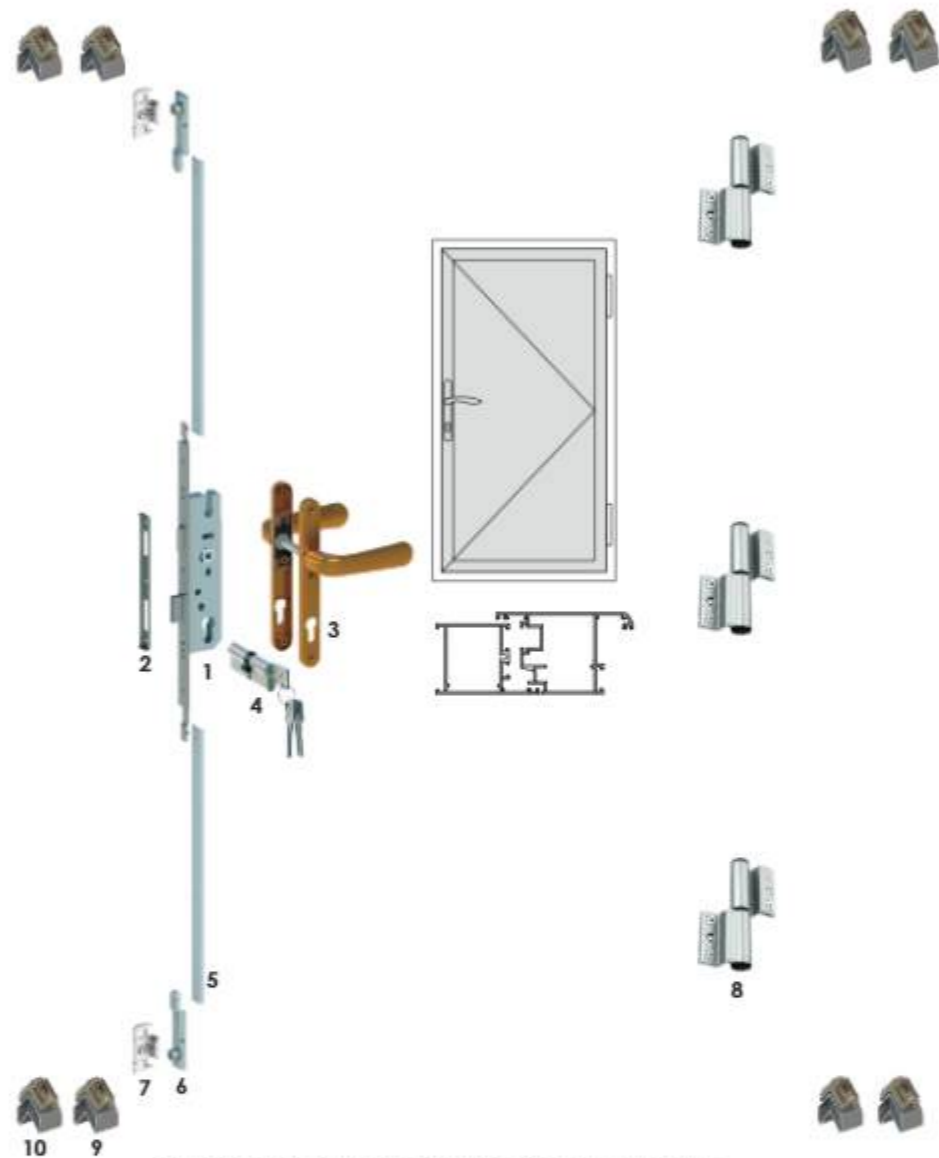

CASEMENT DOOR HARDWARE CONFIGURATION :

NO.	NAME	ITEM NO.	PAGE NO.
1	MULTIPOINT MORTISE LOCK BODY	MLK 85*35	67
2	COUNTER PLATE	CP 01	69
3	MORTICE HANDLE	HD 22P	73
4	CYLINDER WITH ULTRA KEYS	CY 855-2C	75
5	POLYAMIDE STRIP	PLY	30
6	EURO LOCKING PIN	TPLP 02	34
7	ADJUSTABLE STRIKER	TPS 04	33
8	EURO DOOR HINGE	BH 06	78
9	CASEMENT DOOR SASH CORNER CLEAT	CC 50DS	20
10	CASEMENT DOOR FRAME CORNER CLEAT	CC 50DF	20

HANDLE OPTIONS



HD 29



HD 22-AS



HD 27



HD 22T

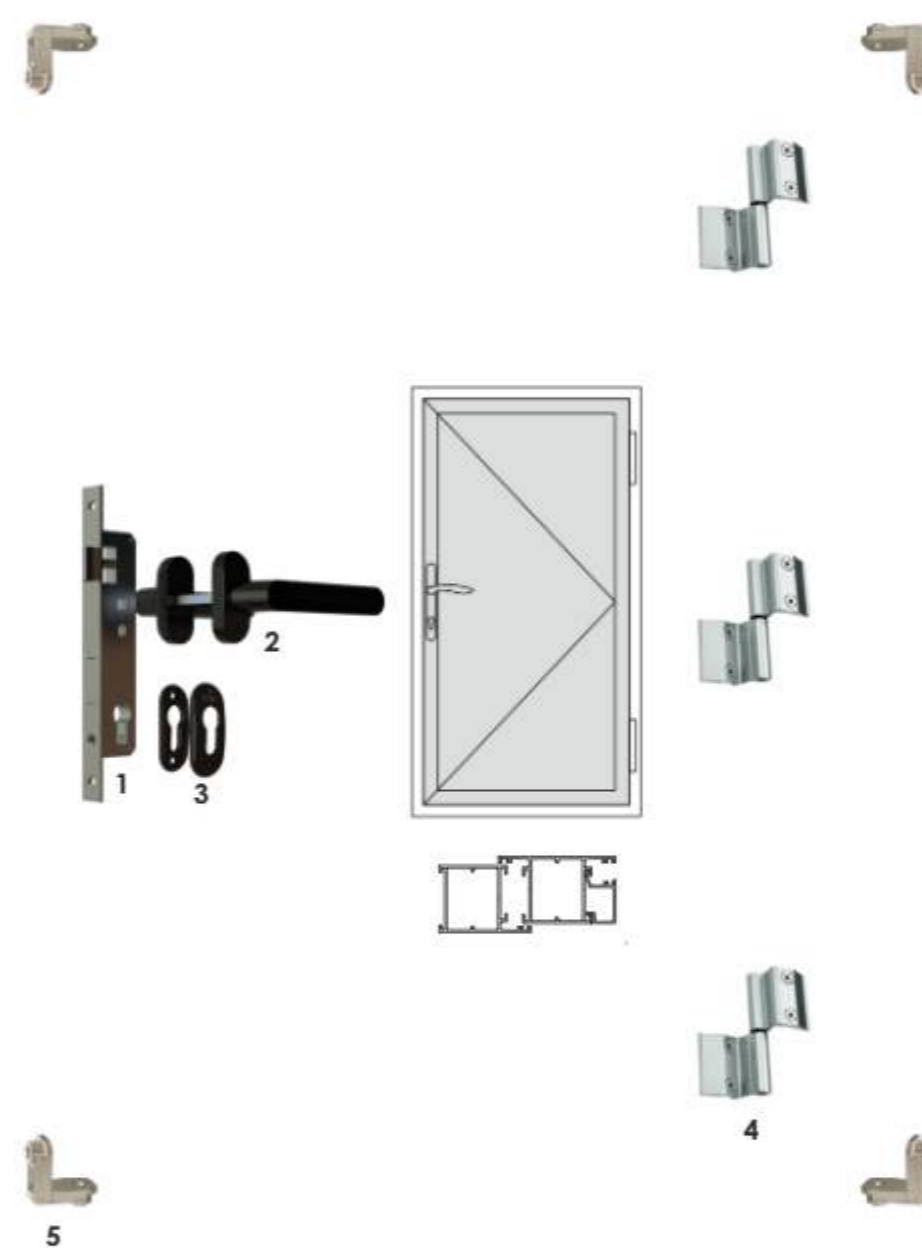

HANDLE OPTIONS



HD 29



HD 22P



HD 27



HD 22T



HD 21

CASEMENT DOOR HARDWARE CONFIGURATION :

NO.	NAME	ITEM NO.	PAGE NO.
1	MORTICE LOCK	LK01 85*25	68
2	MORTICE HANDLE	HD 25	73
3	CYLINDER CAP	CAP 25	74
4	EURO DOOR HINGE	BH 02	77
5	CASEMENT CORNER CLEAT	CC 40	8

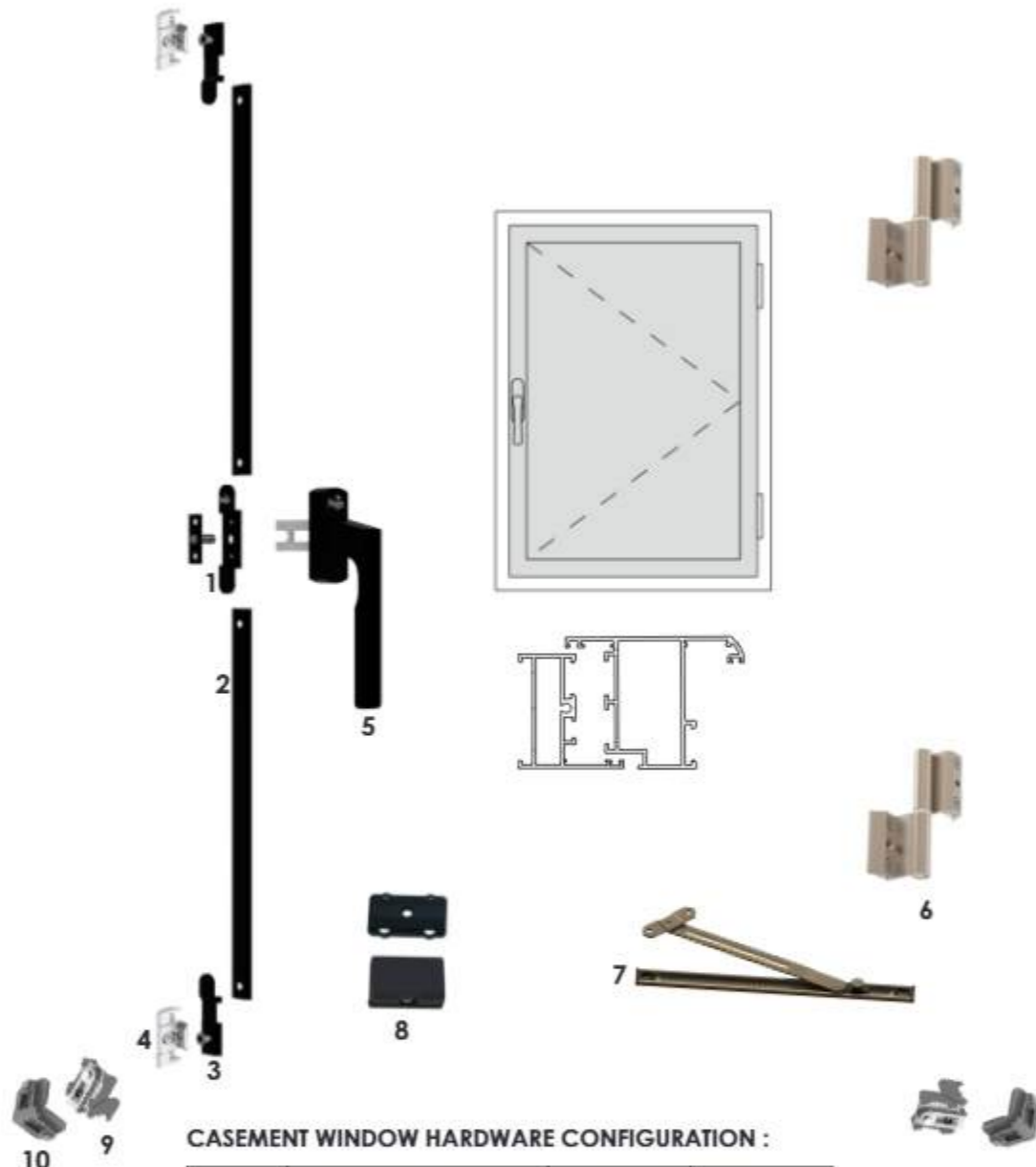

CASEMENT WINDOW HARDWARE CONFIGURATION :

NO.	NAME	ITEM NO.	PAGE NO.
1	EURO T CONNECTOR	TPT 02	34
2	POLYMIDE STRIP	PLY	30
3	EURO LOCKING PIN	TPLP 02	34
4	ADJUSTABLE STRIKER	TPS 04	33
5	CREMONE HANDLE	SL 54F	42
6	EURO HINGE	BH 01	77
7	EURO GROOVE ARM STAY	ERA	27
8	NYLON SASH LIFTER	HD 62	24
9	CORNER CLEAT WINDOW SHUTTER	CC 50WS	8
10	CORNER CLEAT WINDOW FRAME	CC 50WF	8

HANDLE OPTIONS



HD 14



HD 17



HD 112



HD 12K



HD 13

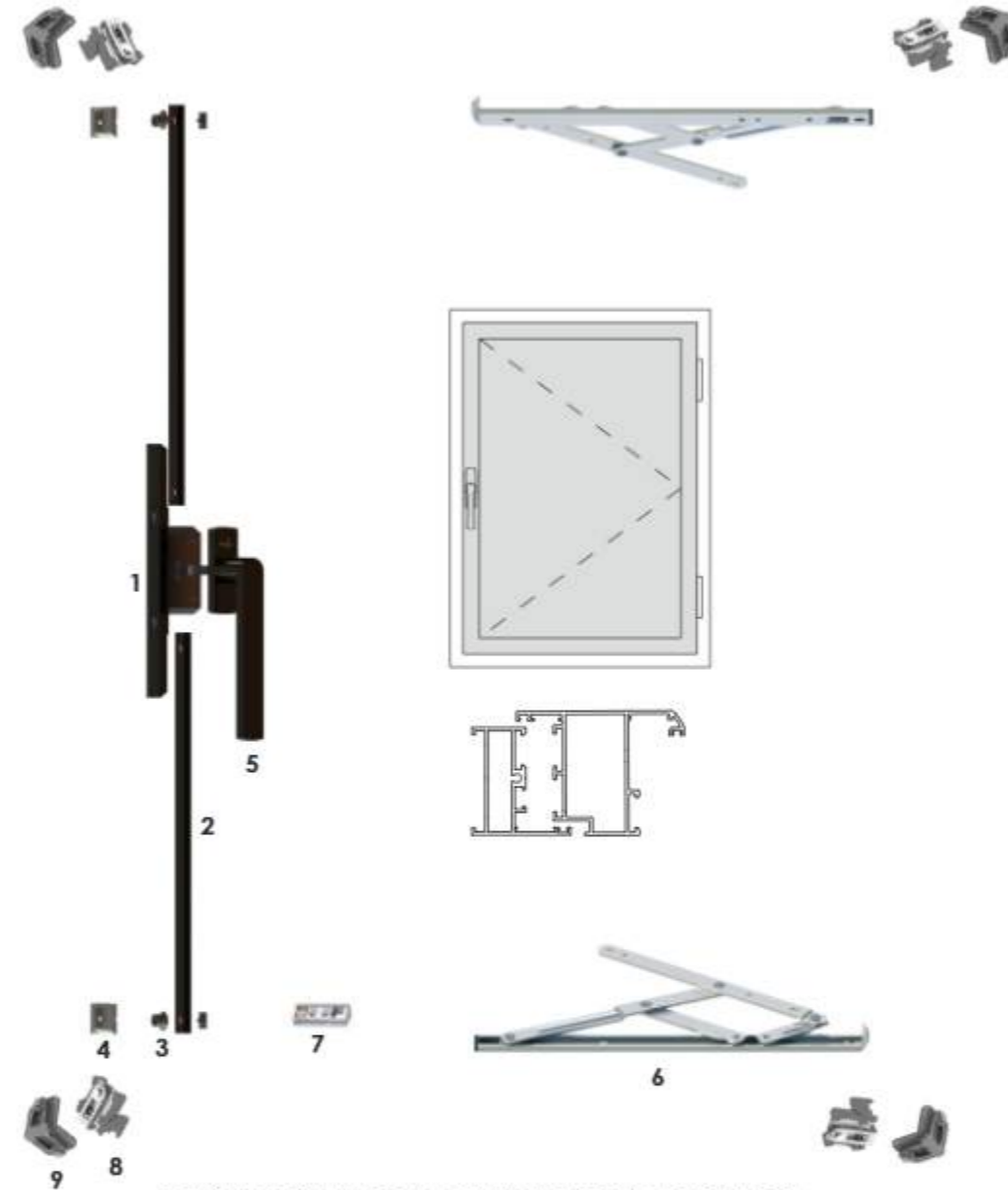

CASEMENT WINDOW HARDWARE CONFIGURATION :

NO.	NAME	ITEM NO.	PAGE NO.
1	GEAR BOX	GB 20	31
2	POLYMIDE STRIP	PLY	30
3	LOCKING POINT	TPLP	33
4	EURO STRIKIER	TPS 01	33
5	CASEMENT WINDOW HANDLE	HD 39	
6	EURO GROOVE FRICTION STAY	EUR-CH-FS	27
7	ROLLON SASH LIFTER	HD 61	24
8	CORNER CLEAT WINDOW SHUTTER	CC 50WS	8
9	CORNER CLEAT WINDOW FRAME	CC 50WF	8

HANDLE OPTIONS



HD 37



HD 43

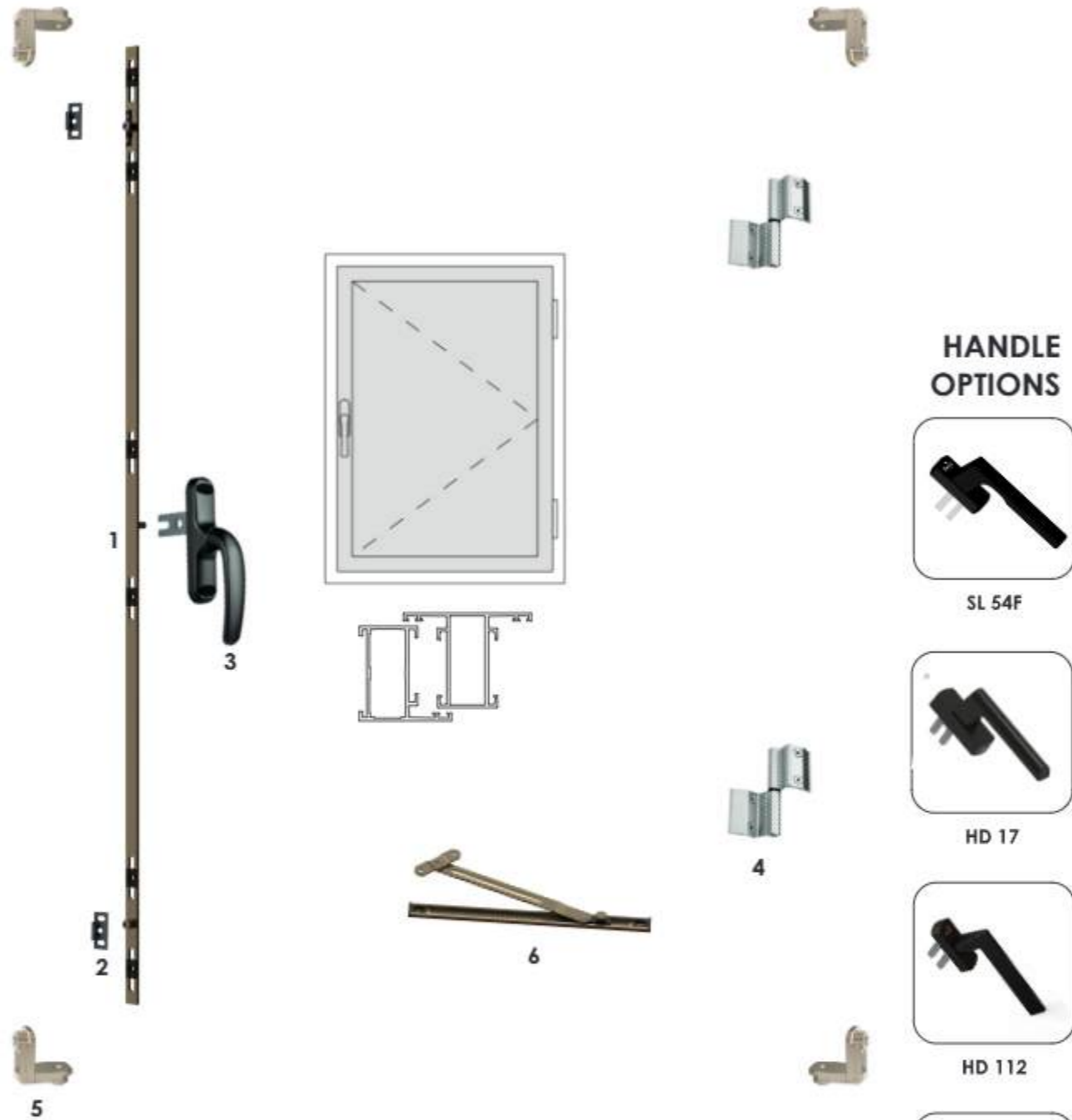

HANDLE OPTIONS



SL 54F



HD 17



HD 112



HD 12K



HD 13

CASEMENT WINDOW HARDWARE CONFIGURATION :

NO.	NAME	ITEM NO.	PAGE NO.
1	TRANSMISSION ROD	CAS-TPG	29
2	STRIKER	TPS 02	33
3	CREMONE FORK HANDLE	HD 14	41
4	BUT HINGES	BH 02	77
5	CORNER CLEAT	CC 40	8
6	RESTRICTOR ARM	RA	26

(NON EURO GROOVE PROFILE)

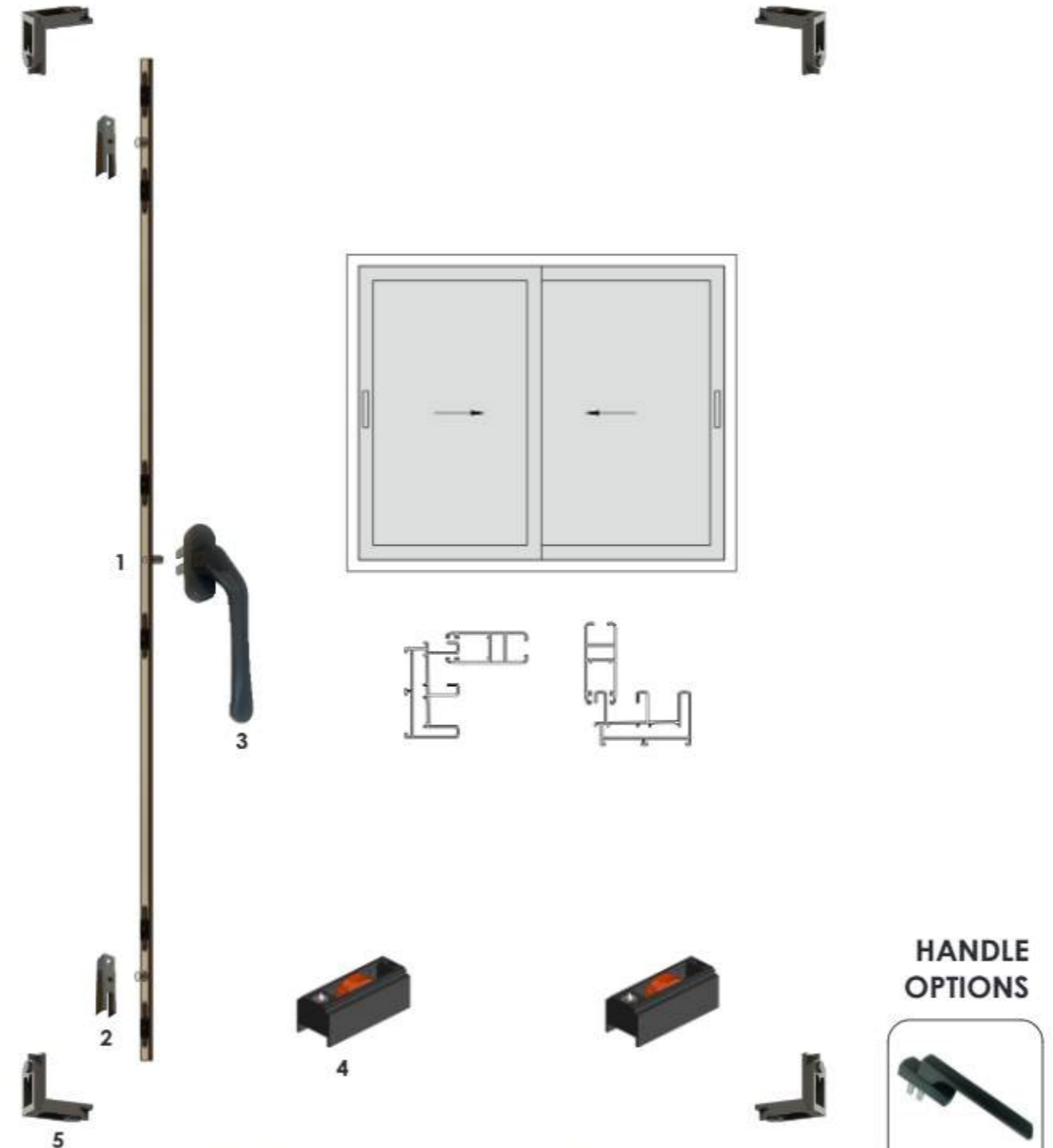

HANDLE OPTIONS



SL 50F



SL 47FT

SLIDING WINDOW HARDWARE CONFIGURATION :

NO.	NAME	ITEM NO.	PAGE NO.
1	SLIDING TRANSMISSION ROD	SLID-TPG	29
2	SLIDING STRIKER	SCP 11	36
3	SLIDING CREMONE HANDLE	SL 47F	43
4	ADJUSTABLE SINGLE WHEEL ROLLER	SR 05	59
5	CORNER CLEAT	CC 27	19

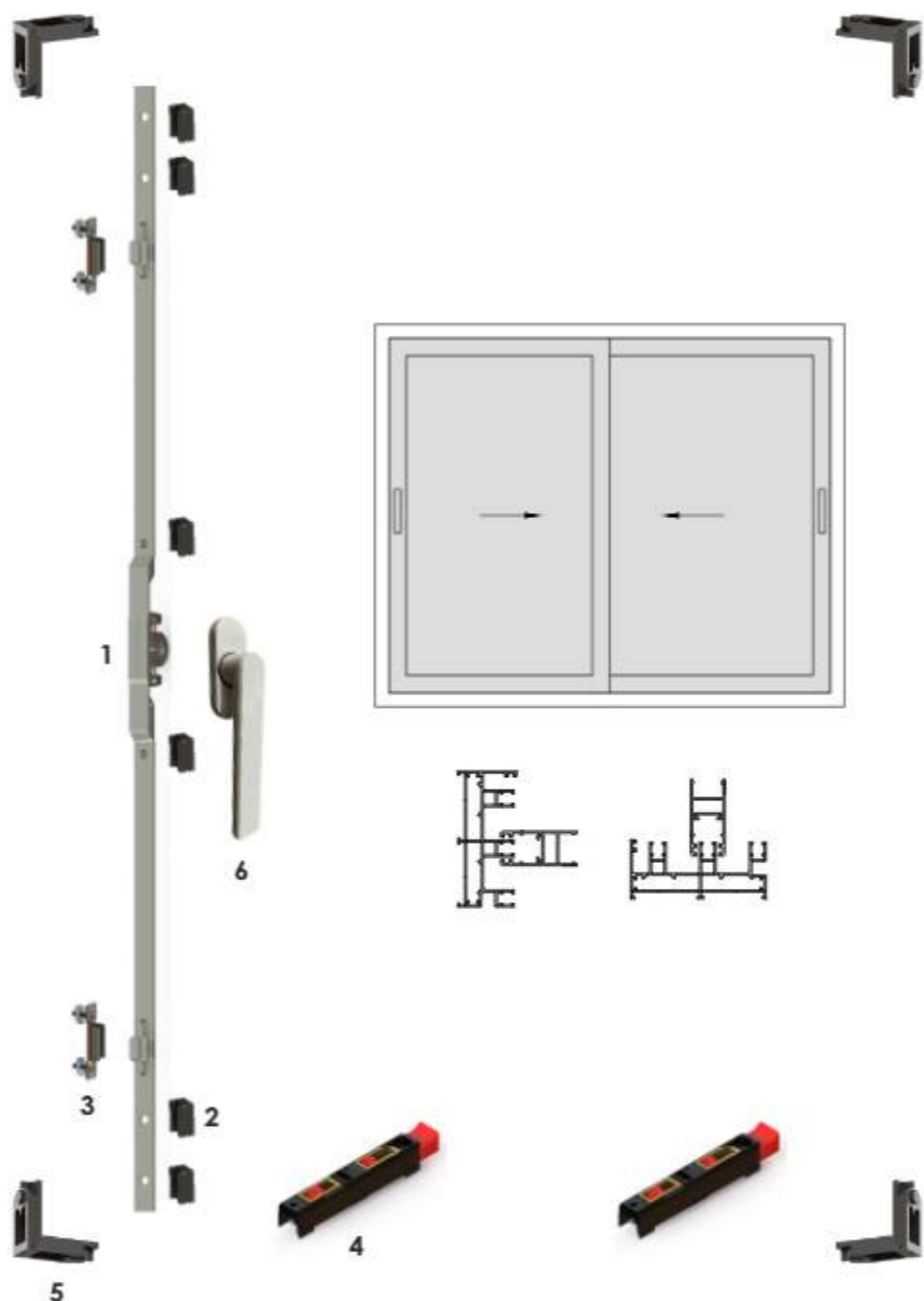

HANDLE OPTIONS



SL 38



SL 47FT



SL 111



SL 47



SL 47K

SLIDING WINDOW HARDWARE CONFIGURATION :

NO.	NAME	ITEM NO.	PAGE NO.
1	SLIDING ESPAGE 7.5MM	SWG	29
2	PVC ADUSTER	PVC-ADJ	
3	SLIDING STRIKER	SCP 14	36
4	ADJUSTABLE DOUBLE ROLLER	SR 01BB	59
5	CORNER CLEAT	CC 29	19
6	TRANSMISSION SHORT NECK HANDLE	SL 50	46

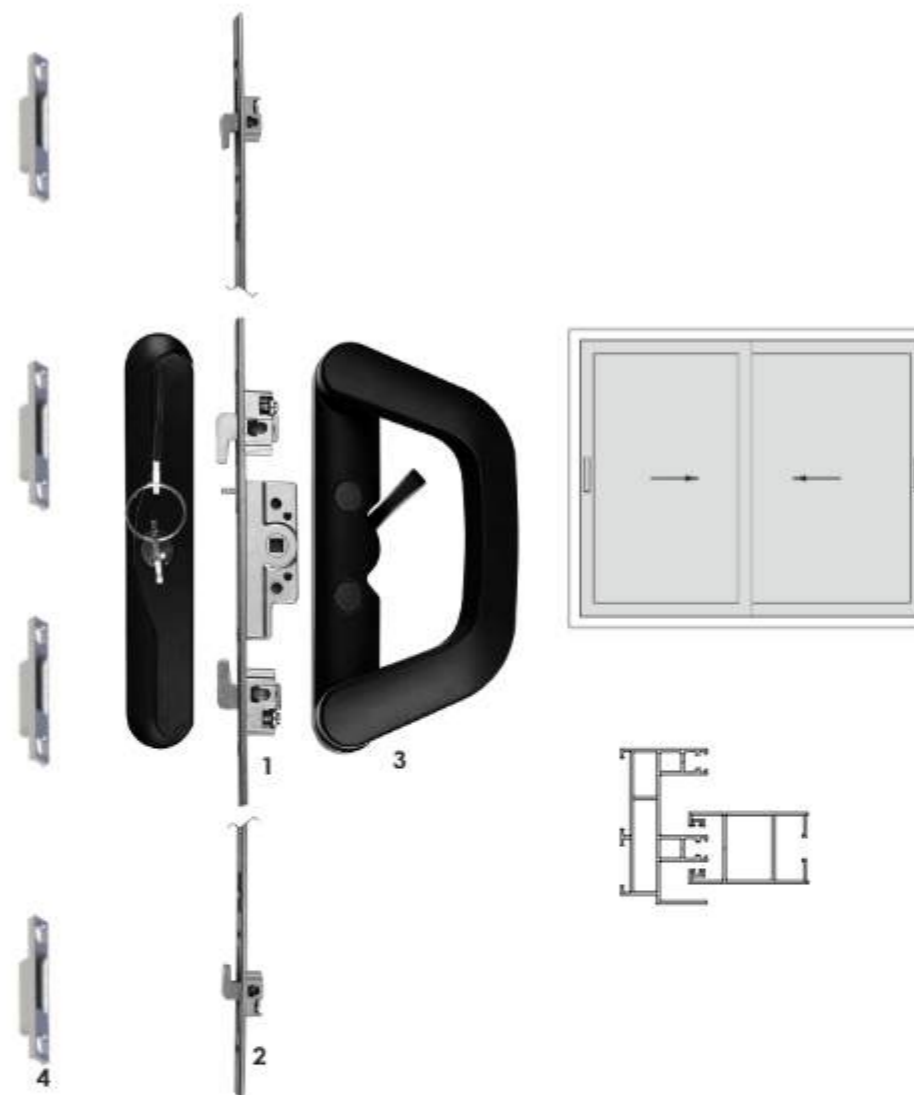

HANDLE OPTIONS



SL 91



SL 45



SL 54



SL 111

SLIDING WINDOW HARDWARE CONFIGURATION :

NO.	NAME	ITEM NO.	PAGE NO.
1	U BEND GEAR BOX	UBGB	30
2	U BEND EXTENSION-TOP/BOTTOM	UB-EXT	30
3	SLIDING HANDLE	SL 71	45
4	SLIDING STRIKER	SCP 04	35

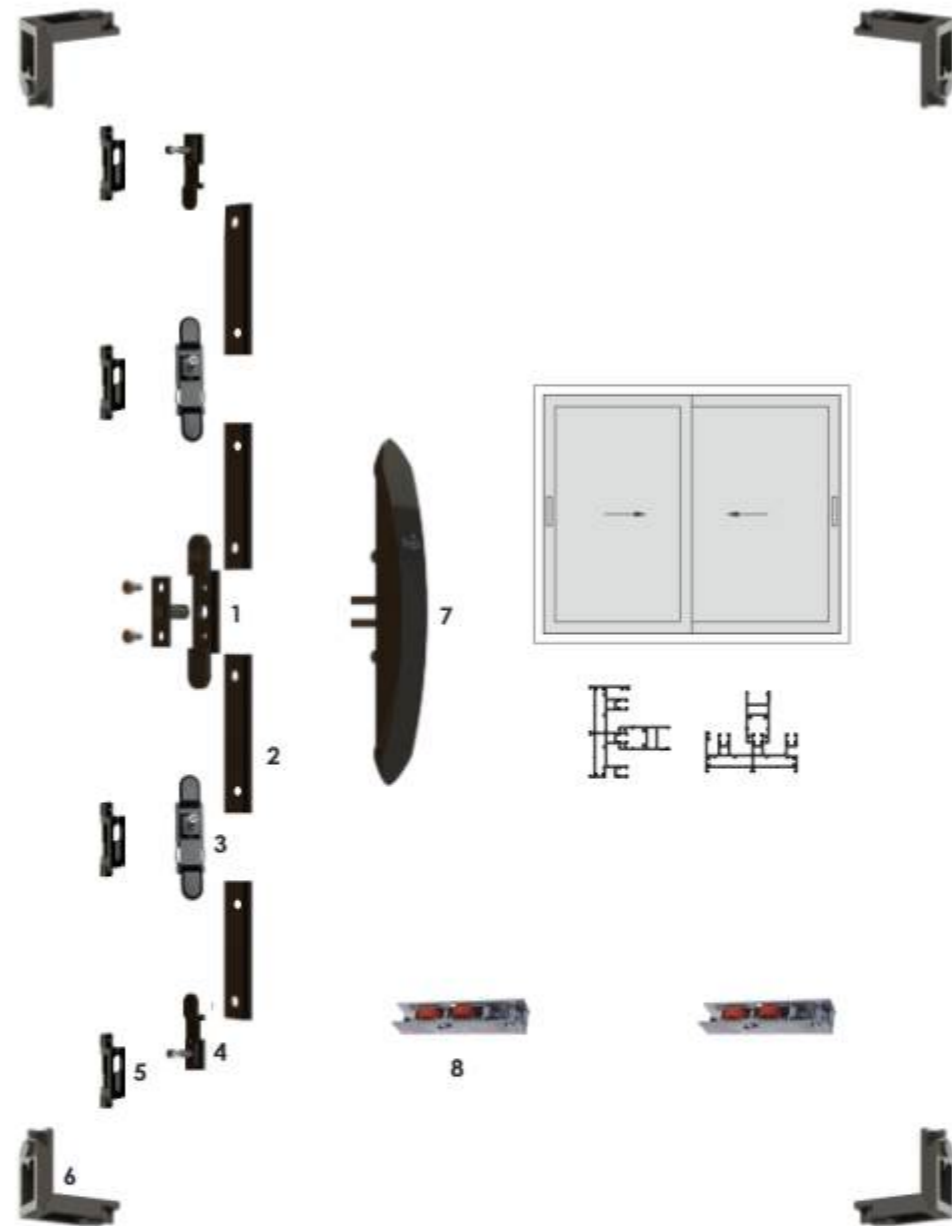

HANDLE OPTIONS



SL 81



SL 82



SL 83



SL 74



SL 101



SL 102

SLIDING WINDOW HARDWARE CONFIGURATION :

NO.	NAME	ITEM NO.	PAGE NO.
1	EURO T CONNECTOR	TPT 02	34
2	POLYAMIDE	PLY	30
3	TWO WAY LOCKING PIN	SN 12	38
4	SINGLE WAY LOCKING PIN	SN 11	38
5	STRIKER	SCP 12	36
6	CORNER CLEAT	CC 29	19
7	SLIDING FORK HANDLE	SL 85	56
8	ADJUSTABLE DOUBLE ROLLER	SR 44	60

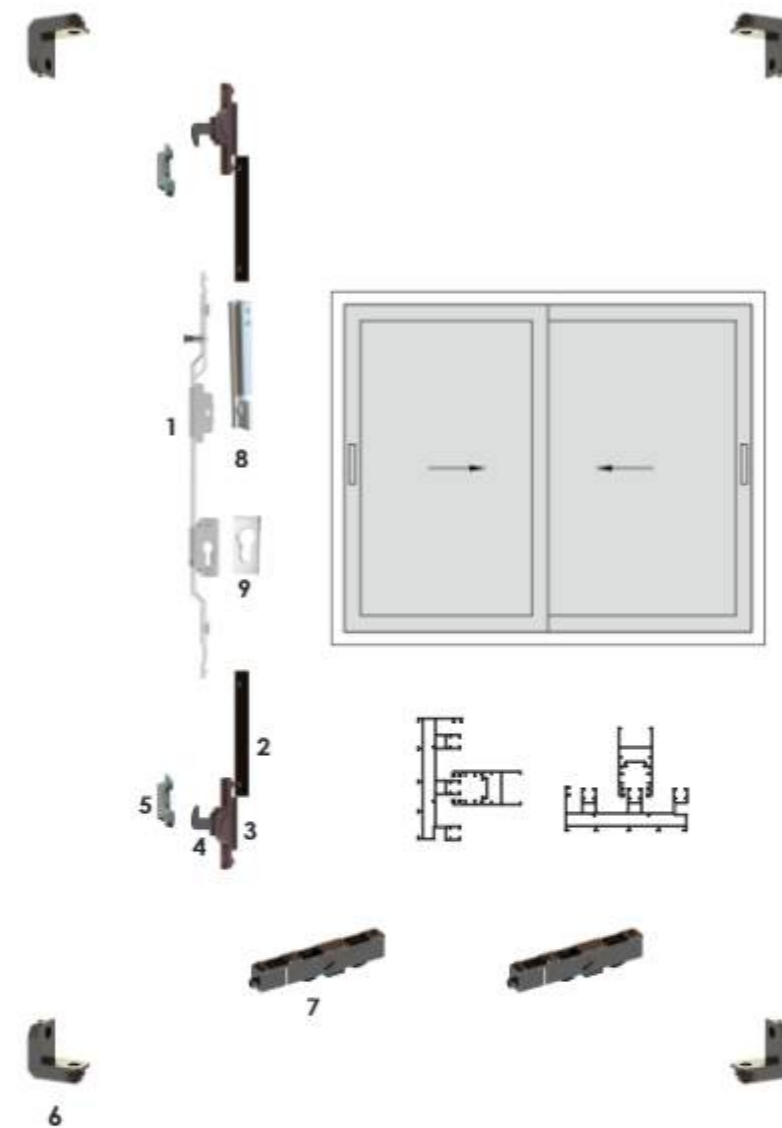

SLIDING WINDOW HARDWARE CONFIGURATION :

NO.	NAME	ITEM NO.	PAGE NO.
1	CYLINDER GEARBOX 7MM	GB-CY-07	32
2	POLYAMIDE	PLY	30
3	NIB HOLDER	SN 04	25
4	J HOOK	SN 03	25
5	STRIKER	SCP 05	36
6	CORNER CLEAT	CC 37	19
7	ADJUSTABLE U GROOVE ROLLER	SR 54	62
8	SLIDING LOCKABLE HANDLE	SL 111	49
9	CYLINDER CAP	CAP 21	74

HANDLE OPTIONS



SL 50



SL 111

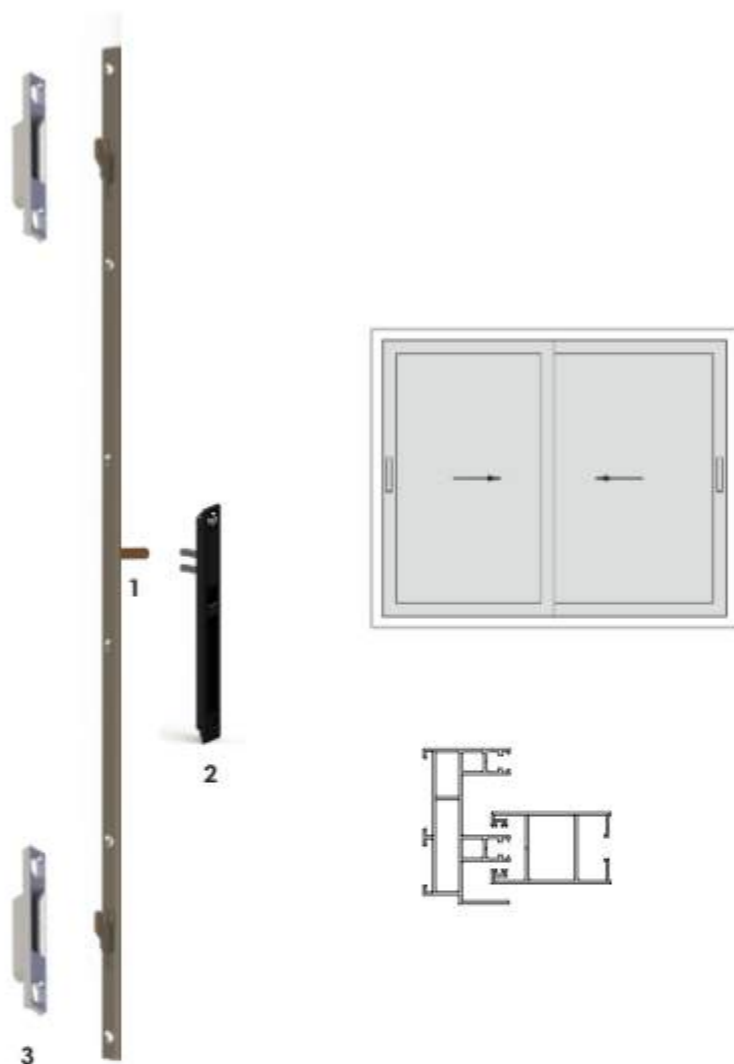

HANDLE
OPTIONS



SL 14F



SL 75



SL 76



SL 86

SLIDING WINDOW HARDWARE CONFIGURATION :

NO.	NAME	ITEM NO.	PAGE NO.
1	NON EURO TRANSMISSION ROD	SLID-UTPG-HK	29
2	CONCEALED MULTI POINT HANDLE	SL 80	53
3	SLIDING STRIKER	SCP 04	35

CORNER CLEATS



CASEMENT CLEAT
(40/52MM SERIES)

CC 40

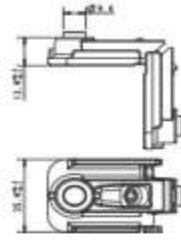

CASEMENT DOOR
CORNER CLEAT

CC 1010

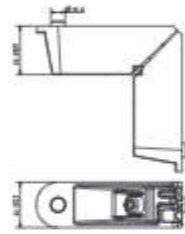

CASEMENT WINDOW
CORNER CLEAT
(50MM SERIES:
WINDOW SASH)

CC 50WS

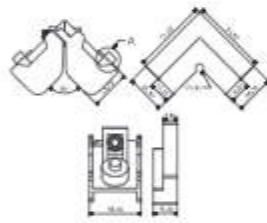

CASEMENT WINDOW
CORNER CLEAT
(50MM SERIES:
WINDOW FRAME)

CC 50WF

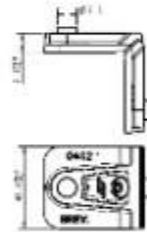

CORNER CLEAT

CC 3610

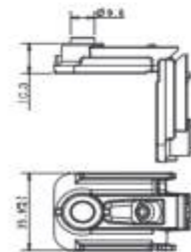

SLIDING CORNER
CLEAT
(27MM SERIES)

CC 27

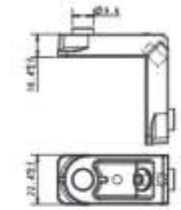

SLIDING CORNER
CLEAT
(29MM SERIES)

CC 29

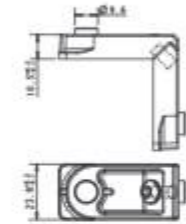

SLIDING CORNER
CLEAT (37MM SERIES)

CC 37

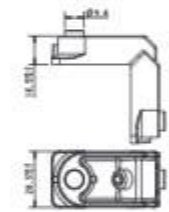

SLIDING CORNER
CLEAT
(35 MM SERIES)

CC 35

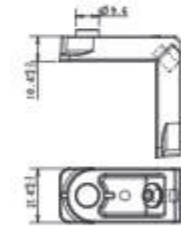

CASEMENT CORNER
CLEAT

CC 2610

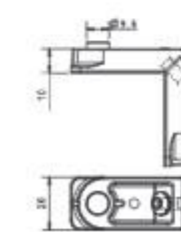

CASEMENT DOOR
CORNER CLEAT
(50MM SERIES:
DOOR SASH)

CC 50DS

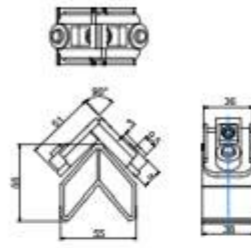

CASEMENT DOOR
CORNER CLEAT
(50MM SERIES:
DOOR FRAME)

CC 50DF

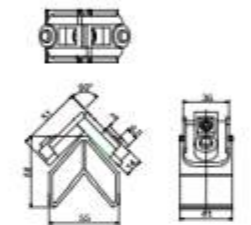

CORNER CLEAT

CC 3629

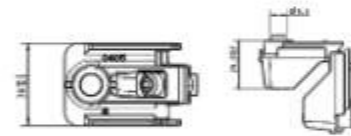

CORNER CLEAT

CC 3211

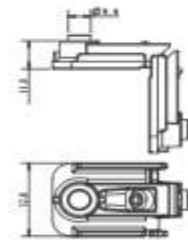

CORNER CLEAT

CC 443

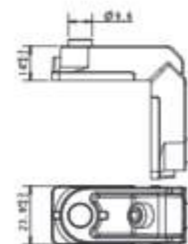

MULLION CONNECTOR
(50MM SERIES)

MC 50

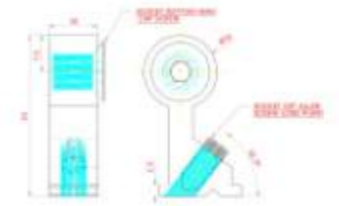

MULLION CONNECTOR
(40MM SERIES)

MC 40A

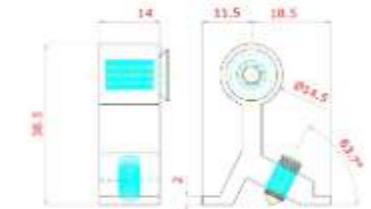

MULLION CONNECTOR
(40MM SERIES)

MC 40B

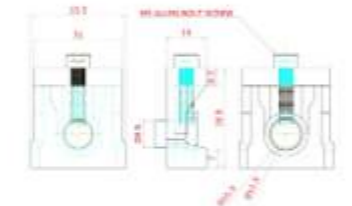

SLIDING MULLION
CONNECTOR
(27/29MM SERIES)

MC 29

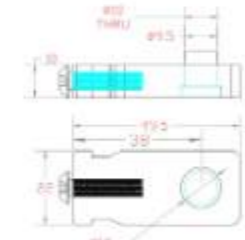

SLIDING MULLION
CONNECTOR
(27/29MM SERIES)

MC 32

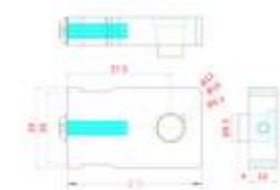

COCKSPUR HANDLES



SINGLE POINT
WINDOW HANDLE
(LEFT/RIGHT)

HD 03

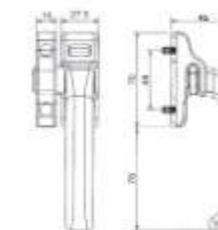

SINGLE POINT
WINDOW HANDLE
(LEFT/RIGHT)

HD 06

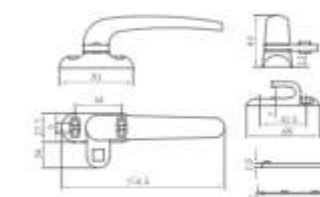

SINGLE POINT
WINDOW HANDLE
(LEFT/RIGHT)

HD 08

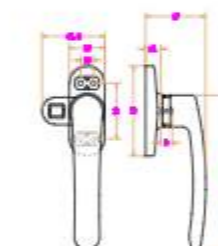

SINGLE POINT
WINDOW HANDLE
(LEFT/RIGHT)

HD 10

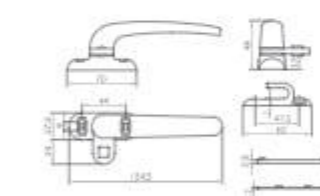

SINGLE POINT WINDOW
HANDLE WITH KEY
(LEFT/RIGHT)

HD 02

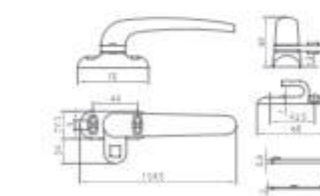

SINGLE POINT
WINDOW HANDLE
(LEFT/RIGHT)

HD 09

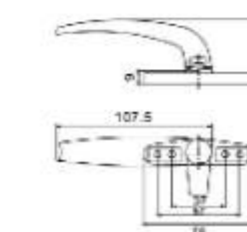

FRICION STAYS



STAINLESS STEEL
FRICION STAY
(BAR THICKNESS: 2mm)

FS



PRODUCT CODE	Hinge Size (in/mm)	Stick Height (mm)	Side Hung		Top Hung		Load Capacity (kg)	Opening Angle (+/- 2.5°)
			Max Shutter Width (mm)	Max Shutter Height (mm)	Max Shutter Width (mm)	Max Shutter Height (mm)		
FS 08 A	08/205	13.5	450	900	900	450	8	87.5
FS 10 A	10/255	13.5	500	850	850	500	10	87.5
FS 12 A	12/310	13.5	550	1200	1200	550	12	87.5
FS 14 A	14/355	13.5	650	1200	1200	650	15	87.5
FS 16 A	16/405	13.5	650	1350	1350	650	17	87.5

STAINLESS STEEL
FRICION STAY
(BAR THICKNESS: 2.5MM)

FS -B

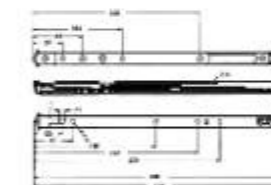

PRODUCT CODE	Hinge Size (in/mm)	Stick Height (mm)	Side Hung		Top Hung		Load Capacity (kg)	Opening Angle (+/- 2.5°)
			Max Shutter Width (mm)	Max Shutter Height (mm)	Max Shutter Width (mm)	Max Shutter Height (mm)		
FS 10 B	10/255	16	500	1100	1100	500	12	87.5
FS 12 B	12/310	16	575	1200	1200	575	16	87.5
FS 14 B	14/355	16	650	1350	1350	650	19	87.5
FS 16 B	16/405	16	700	1500	1500	700	21	87.5
FS 18 B	18/455	16	750	1600	1600	750	23	87.5

STAINLESS STEEL
FRICION STAY
(HEAVY DUTY)

FS-C



PRODUCT CODE	Hinge Size (in/mm)	Stock Height (mm)	Side Flang		Top Flang		Load Capacity (kgs)	Opening Angle (+/- 2.5°)
			Max Shuffer Width (mm)	Max Shuffer Height (mm)	Max Shuffer Width (mm)	Max Shuffer Height (mm)		
FS 10 C	10/255	16	600	1200	1200	600	22	87.5
FS 12 C	12/310	16	650	1300	1300	650	30	87.5
FS 14 C	14/355	16	700	1400	1400	700	34	87.5
FS 16 C	16/405	16	750	1500	1500	750	40	87.5
FS 20 C	20/505	16	NA	NA	1500	1500	80	30
FS 24 C	24/555	16	NA	NA	1500	1700	100	30

SINGLE X
PARALLEL STAY

PS-X

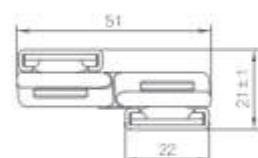

SIZE: 12", 18"

DOUBLE XX
PARALLEL STAY

PS-XX

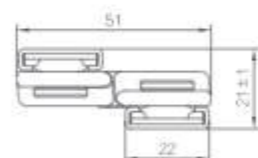

SIZE: 24"

STAINLESS STEEL
RESTRICTOR ARM

RA

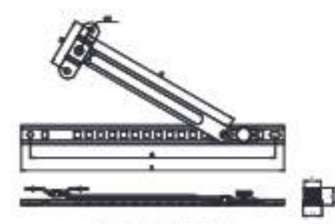

SIZE: 10", 12"

EURO GROOVE
HEAVY DUTY STAY

EFS



PRODUCT CODE	Hinge Size (in/mm)	Stock Height (mm)	Side Flang		Top Flang		Load Capacity (kgs)	Opening Angle (+/- 2.5°)
			Max Shuffer Width (mm)	Max Shuffer Height (mm)	Max Shuffer Width (mm)	Max Shuffer Height (mm)		
EFS12	12/310	20	650	1300	1300	650	40	87.5
EFS14	14/355	20	750	1600	1400	750	50	87.5

EURO GROOVE
FRICION STAY

EUR-CH-FS



PRODUCT CODE	Hinge Size (in/mm)	Stock Height (mm)	Side Flang		Top Flang		Load Capacity (kgs)	Opening Angle (+/- 2.5°)
			Max Shuffer Width (mm)	Max Shuffer Height (mm)	Max Shuffer Width (mm)	Max Shuffer Height (mm)		
EUR-CH-FS12	12/310	20	650	1300	1300	650	25	87.5
EUR-CH-FS14	14/355	20	700	1400	1400	700	30	87.5
EUR-CH-FS16	16/405	20	750	1500	1500	750	35	87.5

EURO GROOVE
CONCEALED STAY
(LEFT/RIGHT)

CS 02

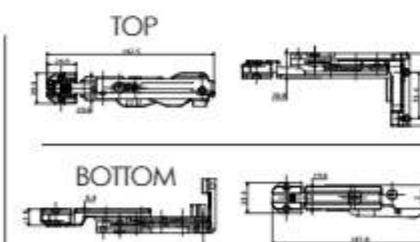

SIZE: 80 KGS

EURO GROOVE
ARM STAY

ERA

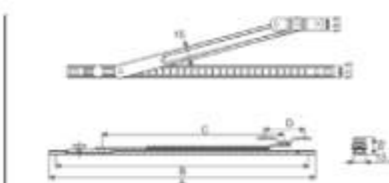

SIZES 10", 12" & 14"

TRANSMISSION SYSTEM

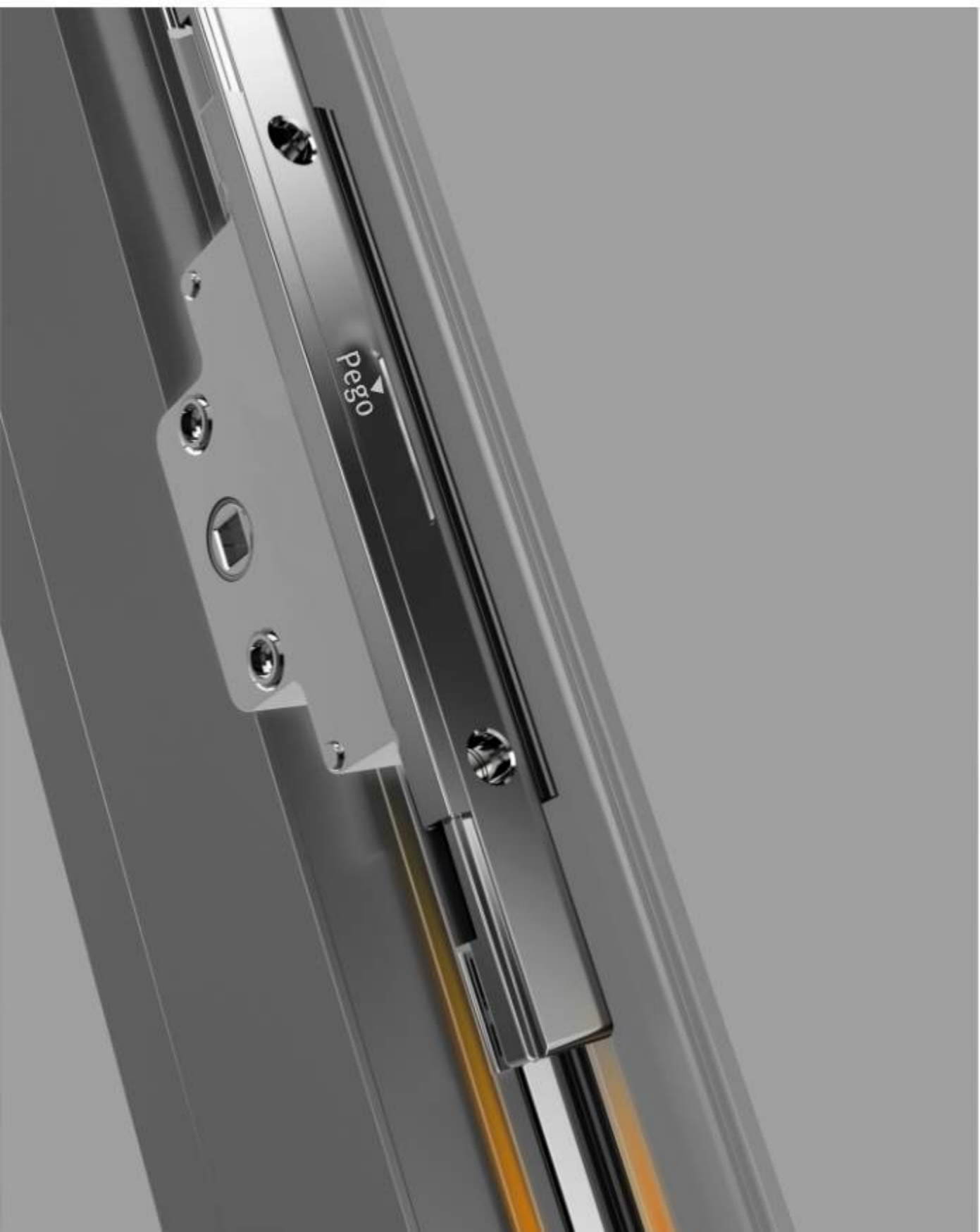

SLIDING WINDOW ESPAGE (7.5MM BASCET)

SWG

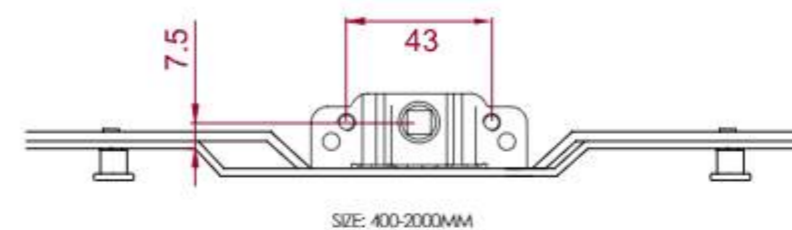

SLIDING NON EURO GEAR

SLID-TPG

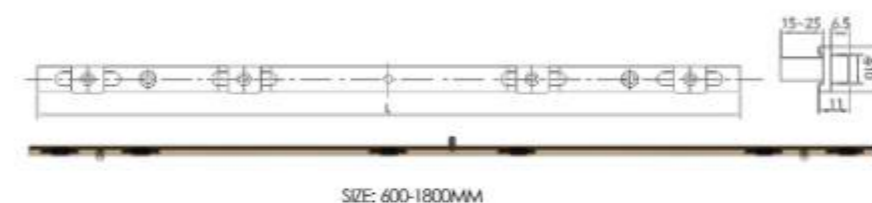

SLIDING NON EURO GEAR

SLID-TPG-HK

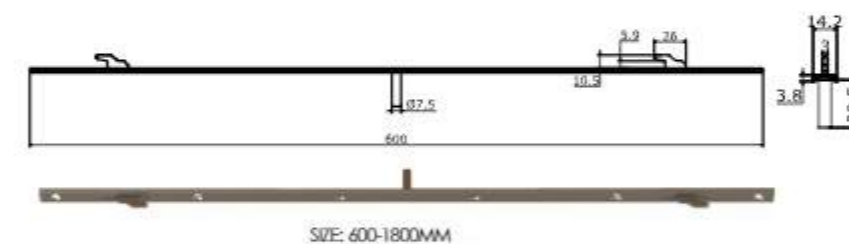

CASEMENT NON EURO GEAR

CAS-TPG



CASEMENT EURO GEAR

EUR-TPG



CASEMENT
EURO EXTENTION GEAR

EUR-EXT



SIZE: 1000MM

TOP HUNG
NON EURO GEAR

FAC-TPG



U BEND GEAR BOX
(20 MM BACSET)

UBGB

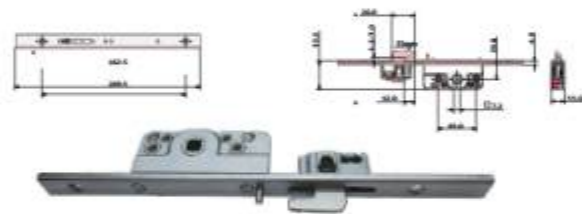

U BEND EXTENSION GEAR
(TOP/BOTTOM)

UB-EXT

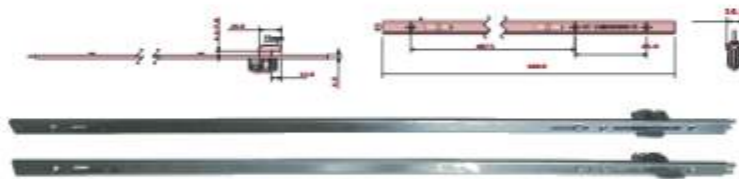

POLYAMIDE

PLY



CORNER DRIVE

CD 01



GEAR BOX
(8 MM BACSET)

GB 08



GEAR BOX
(15 MM BACSET)

GB 15



GEAR BOX
(20 MM BACSET)

GB 20

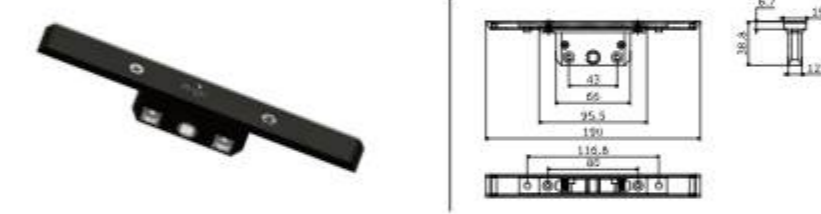

GEAR BOX
(25 MM BACSET)

GB 25



GEAR BOX
(30 MM BACSET)

GB 30



INTEGRATED CYLINDRICAL
GEAR BOX

GB-CY-25



SPINDLE BASE
CYLINDER GEARBOX
(7MM BACSET)

GB-CY-07

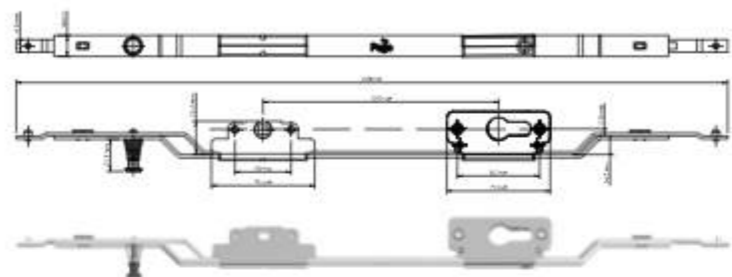

SPINDLE BASE
CYLINDER GEARBOX
(15MM BACSET)

GB-CY-15

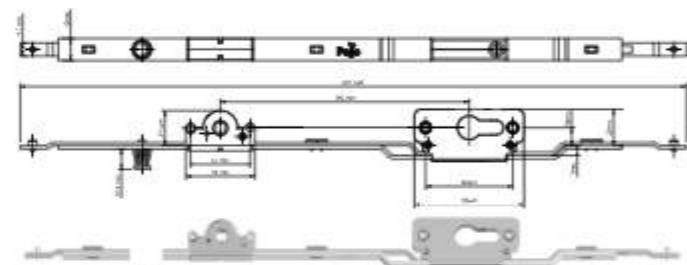

SPINDLE BASE
CYLINDER GEARBOX
(30MM BACSET)

GB-CY-15

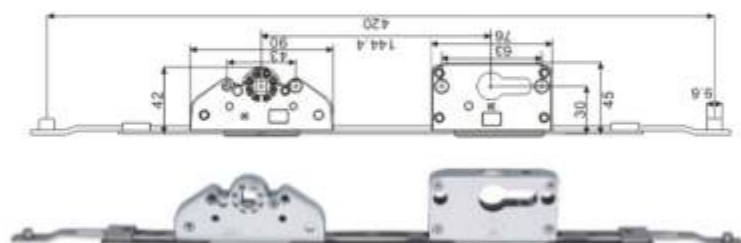

FORK BASE
CYLINDER GEARBOX
(7MM BACSET)

GB-CY-107

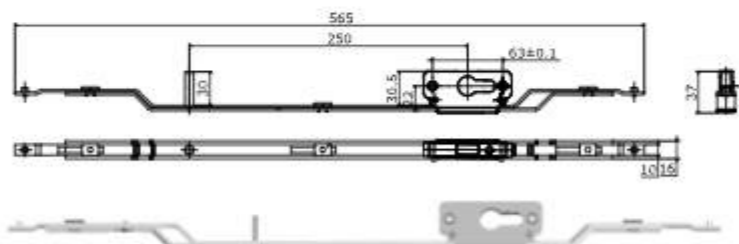

FORK BASE
CYLINDER GEARBOX
(15MM BACSET)

GB-CY-115

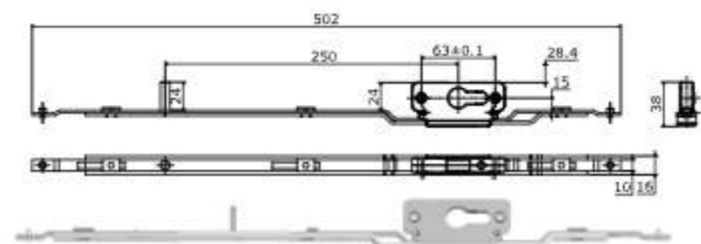

EURO STRIKER

TPS 01

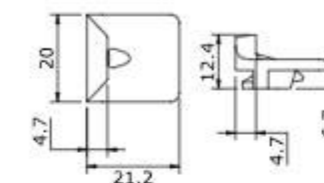
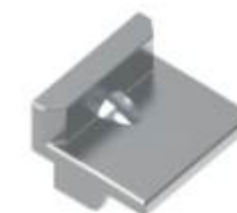

NON EURO
STRIKER

TPS 02

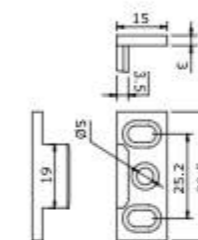

NON EURO
STRIKER

TPS 03

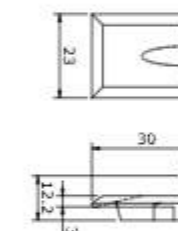

ADJUSTABLE
EURO STRIKER

TPS 04

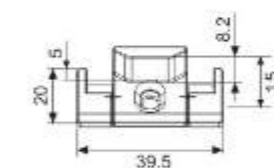

CASEMENT
LOCKING PAUL
(6.5MM)

TPLP 06

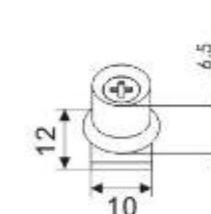

CASEMENT
LOCKING PAUL
(8.5MM)

TPLP 08

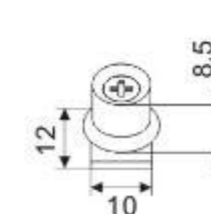

SLIDING J HOOK

SN 03

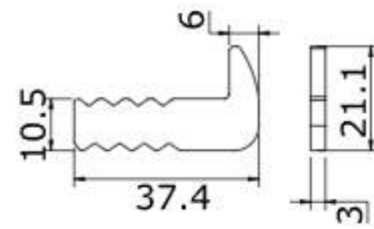

NIB HOLDER

SN 04

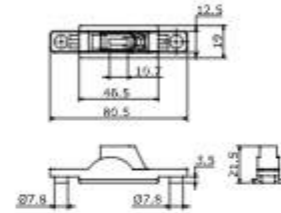

EURO ANTI HANDLING DEVICE

SN 05

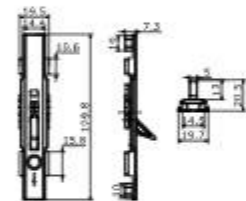

SLIDING NIB

SN 06

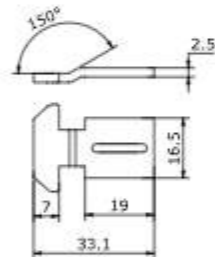

SLIDING ONEWAY LOCKING PIN

SN 11

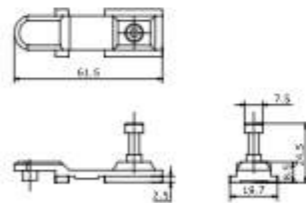

SLIDING TOWAY LOCKING PIN

SN 12

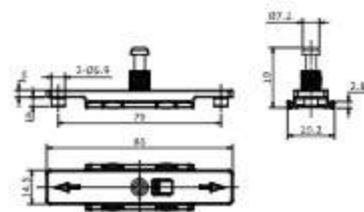

SHOOTBOLT

TB 10-C

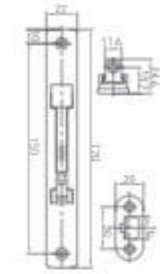

SHOOTBOLT

TB 24-10

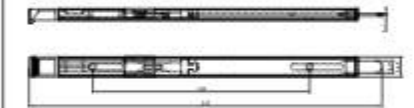

SHOOTBOLT

TB 24-16

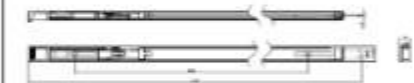

EURO TWO WAY SHOOTBOLT

TB 25

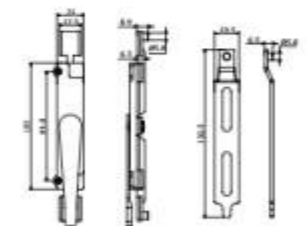

TWO WAY SHOOTBOLT

TB 30

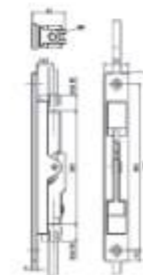

CREMONE HANDLES



CREMONE HANDLES

CREMONE HANDLE
(DOUBLE FORK)

HD 11

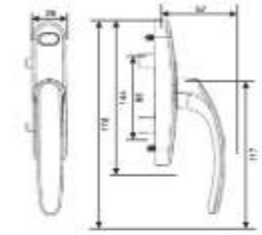

CREMONE HANDLE
(SINGLE FORK)

HD 12

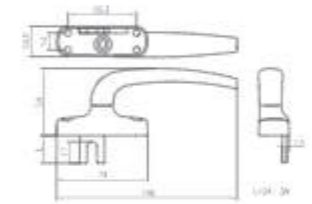

DETACHABLE
CREMONE HANDLE
(SINGLE FORK)

HD 13

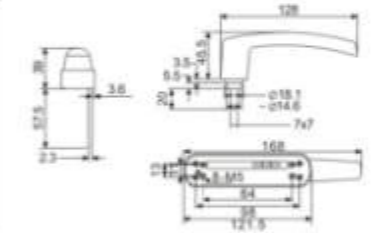

CREMONE HANDLE
(SINGLE FORK)

HD 14

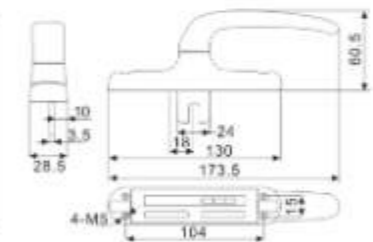

GEAR BOX
(30 MM BACSET)

HD 12K

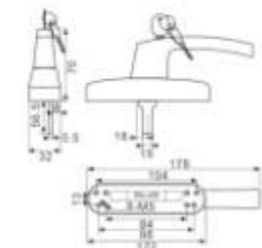

TRANSMISSION HANDLES



SPINDLE TRANSMISSION HANDLES

GEAR BOX
(8 MM BACSET)

SL 34MF

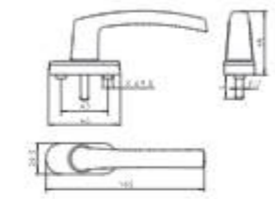

TRANSMISSION
HANDLE

SL 54

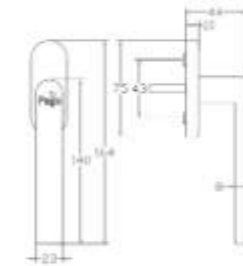

SLIDING LONG
DOOR HANDLE

SL 45

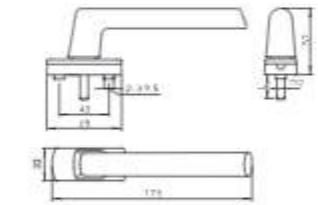

SLIDING LONG
DOOR HANDLE

SL 91

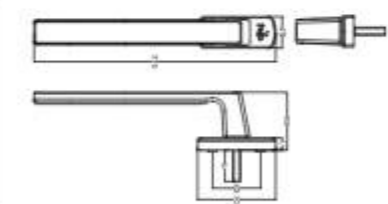

SLIDING D HANDLE
WITH DUMMY HANDLE

SL 71



SHORT NECK
DOOR HANDLE

SL 38

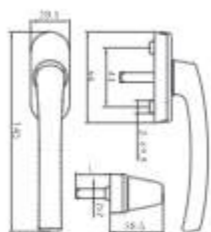

SINGLE POINT
WINDOW HANDLE

SL 50

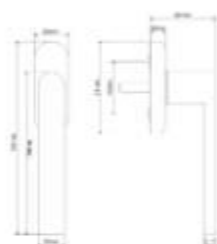

SHORT NECK CRANK
DOOR HANDLE
(LEFT/RIGHT)

SL 47

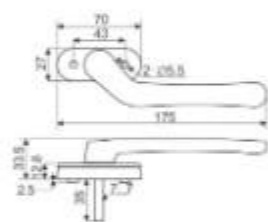

SHORT NECK DOOR
HANDLE (LEFT/RIGHT)

SL 47-FT

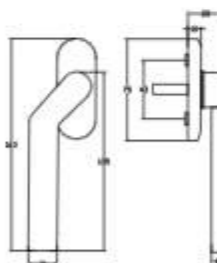

SHORT NECK
DOOR HANDLE

SL 55

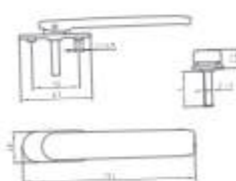

SLIDING LOCKABLE
PATIO HANDLE ON
BOTH SIDES

SL 33

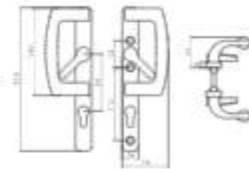

SLIDING NON-LOCKABLE
PATIO HANDLE
WITH DUMMY HANDLE

SL 33RD

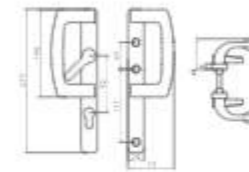

SLIDING LOCKABLE
PATIO HANDLE
WITH DUMMY HANDLE

SL 33D

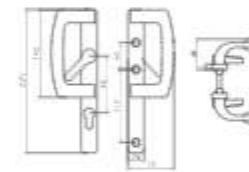

SLIDING NON-LOCKABLE
PATIO HANDLE
WITH RECESSED PLATE

SL 33R

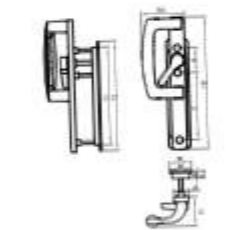

SLIDING LOCKABLE
PATIO HANDLE ON
BOTH SIDES

SL 33-2.5T

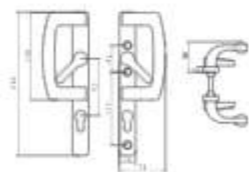

SLIDING NON-LOCKABLE
PATIO HANDLE
WITH DUMMY HANDLE

SL 33RD-2.5T

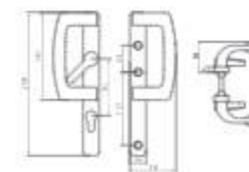

SLIDING LOCKABLE
PATIO HANDLE
WITH DUMMY HANDLE

SL 33D-2.5T

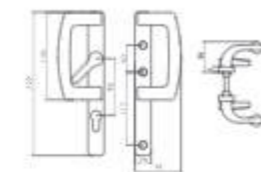

RECESSED DUMMY
HANDLE

SL 15

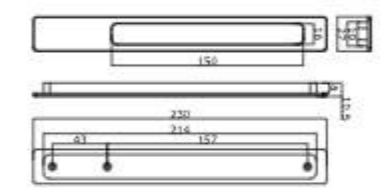

SLIDING UNIVERSAL
HANDLE WITH KNOB

SL 111

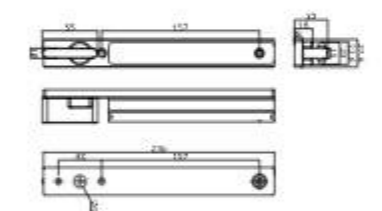

SLIDING UNIVERSAL
OUTSIDE HANDLE
WITH KNOB

SL 112

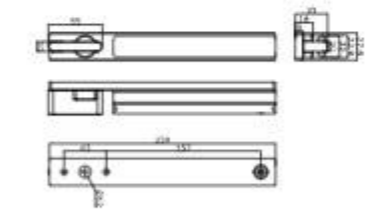

SLIDING UNIVERSAL
OUTSIDE DUMMY
HANDLE

SL 113

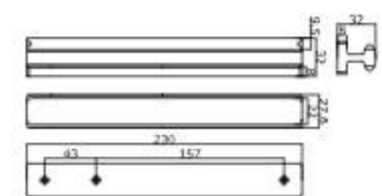

SLIDING LOCKS



SLIDING LOCKS

SLIDING WINDOW
LOCK

SL 01

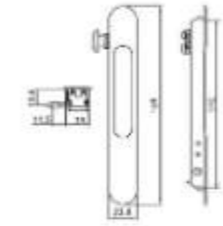

SLIDING DOOR
LOCK

SL 13



SLIDING DOOR
LOCK

SL 14

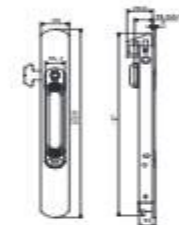

SLIDING DOOR
LOCK

SL 16



SLIDING D HANDLE
WITH LOCKABLE
DUMMY HANDLE

SL 15

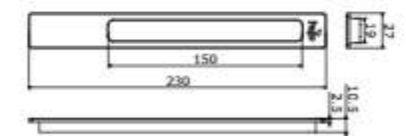

SLIDING DOOR LOCK
WITH KEY

SL 14K



SLIDING DOOR LOCK
WITH KEY

SL 46H

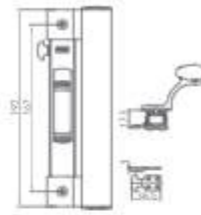

CENTER SLIDING
DOOR HANDLE

SL 11

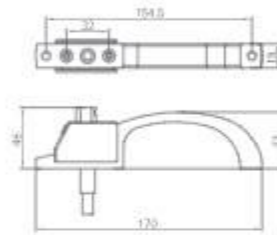

CRESCENT LOCK

SL 36

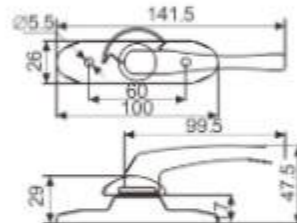

CRESCENT LOCK

SL 36S

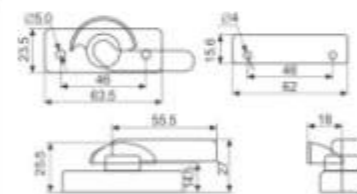

CONCEALED DOOR
HANDLE

SL 63

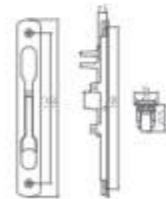

SLIM EXTENDABLE
DOOR HANDLE

SL 78



CONCEALED DOOR
HANDLE

SL 14F

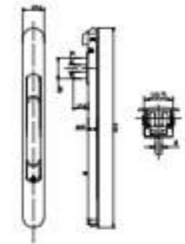

CONCEALED DOOR
HANDLE

SL 75

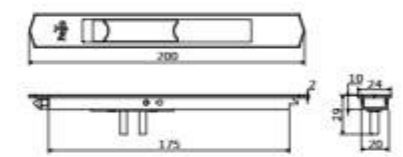

CONCEALED DOOR
HANDLE

SL 80



CONCEALED DOOR
HANDLE WITH
CHILD LOCK

SL 76



CONCEALED DOOR
HANDLE

SL 86

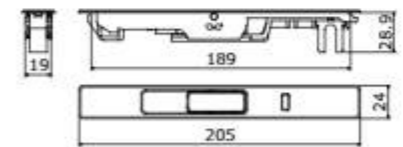

CONCEALED
EXPANDABLE
DOOR HANDLE

SL 79

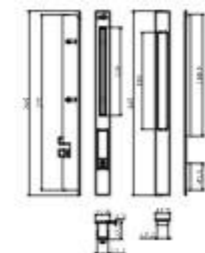

SLIDING PREMIUM HANDLES



SLIDING PREMIUM HANDLES

SLIDING METRO
HANDLE
(LEFT/RIGHT)

SL 74

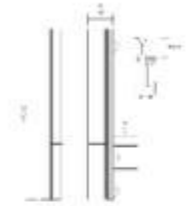

SLIDING METRO
HANDLE

SL 81

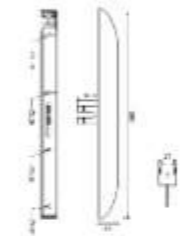

SLIDING MULTI POINT
HANDLE (ON/OFF)
LEFT/RIGHT

SL 82



SLIDING MULTI POINT
UNIVERSAL HANDLE
(ON/OFF) BIG

SL 83



SLIDING MULTI POINT
UNIVERSAL HANDLE
(ON/OFF) SMALL

SL 84

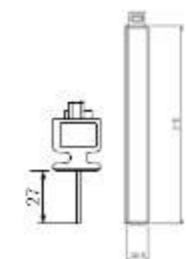

SLIDING BULLET HANDLE

SL 85

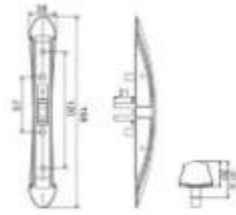

SLIDING MULTI POINT UNIVERSAL HANDLE

SL 101

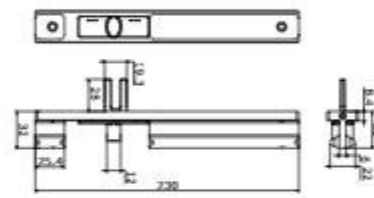

SLIDING MINI MULTIPOINT HANDLE

SL 102

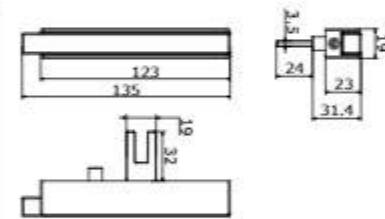

SLIDING OUTSIDE LOCKABLE DUMMY HANDLE

SL 103

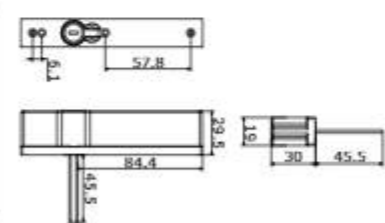

SLIDING SLIM MULTIPOINT HANDLE

SL 104

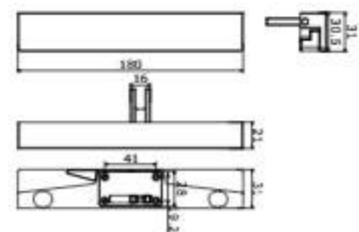

SLIDING SLIM MULTIPOINT HANDLE

SL 105

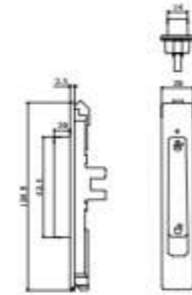

SLIDING SLEEK MULTIPOINT HANDLE

SL 106

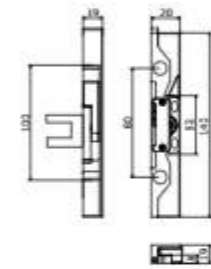

SLIDING SLIMO MULTIPOINT HANDLE

SL 90

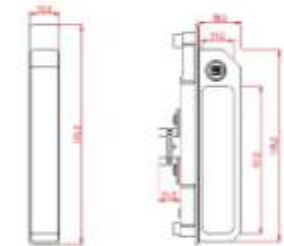

SLIDING OUTSIDE DUMMY HANDLE

SL 82-D

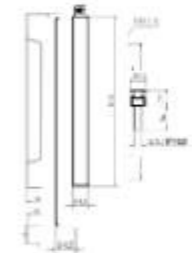

SLIDING OUTSIDE DUMMY HANDLE

SL 83-D

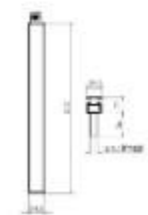

SLIDING ROLLERS

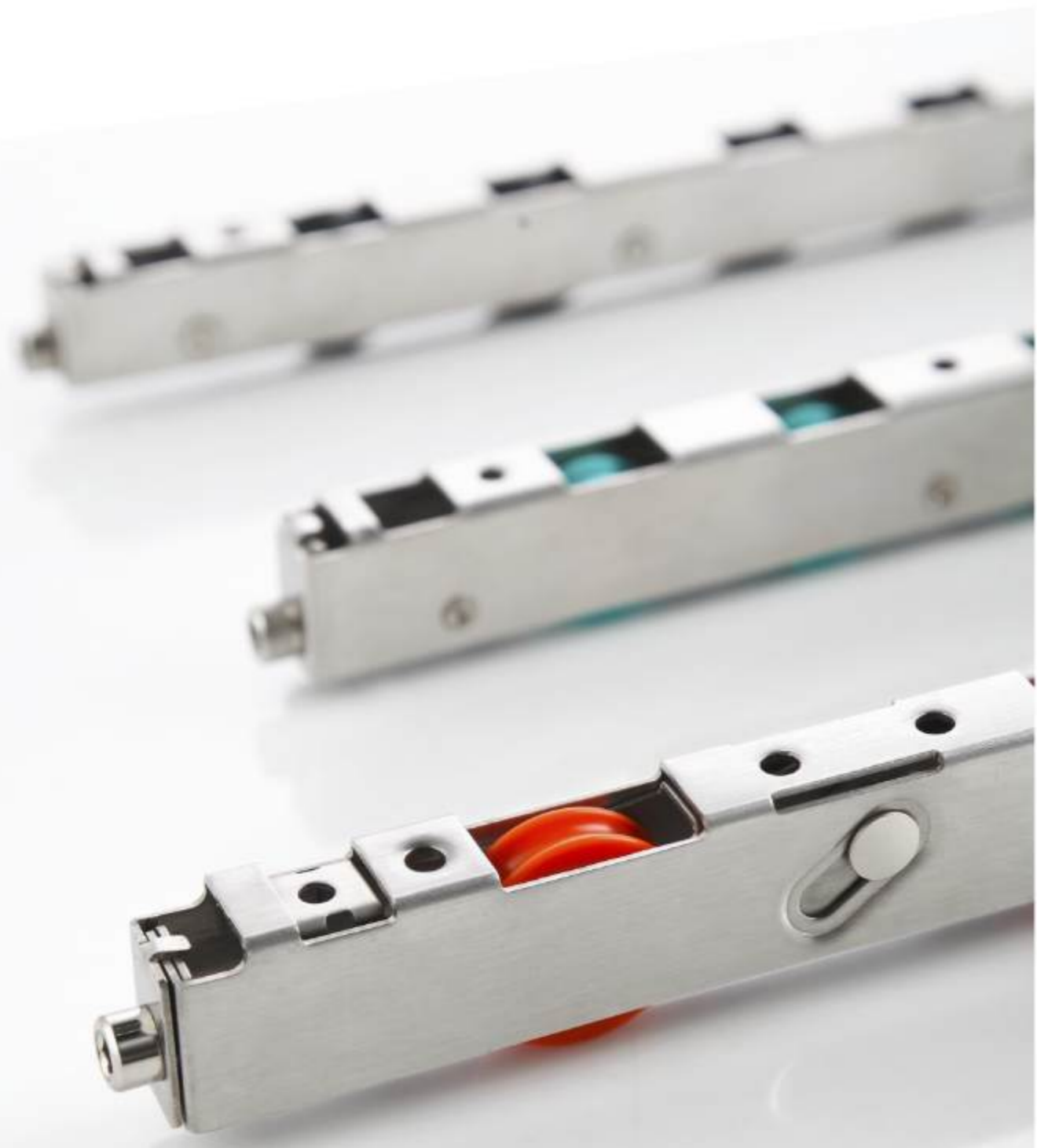

SLIDING ROLLERS

SLIDING DOUBLE
WHEEL ADJUSTABLE
DOOR ROLLER

SR 01

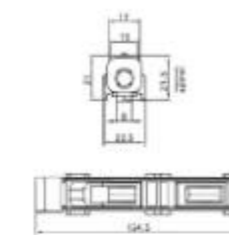

WEIGHT CAPACITY: 70 KGS

SLIDING DOUBLE
WHEEL ADJUSTABLE
DOOR ROLLER
(27/29 MM SERIES)

SR 01BB

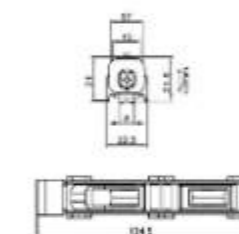

WEIGHT CAPACITY: 120 KGS

SLIDING DOUBLE
WHEEL ROLLER

SR 15

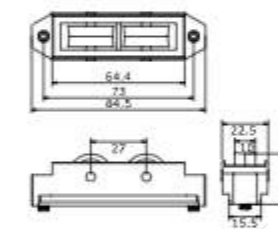

SR15A: 60 KGS
SR15B: 90 KGS

SLIDING
WINDOW ROLLER
(27/29 MM SERIES)

SR 05

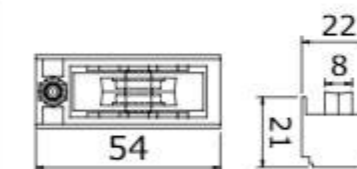
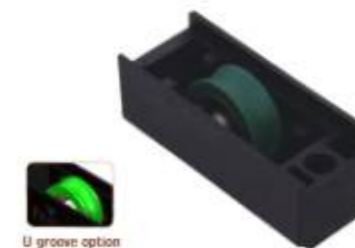

WEIGHT CAPACITY: 30 KGS

SLIDING
WINDOW ROLLER

SR 07

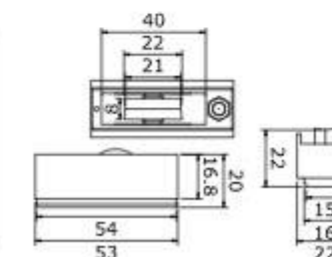
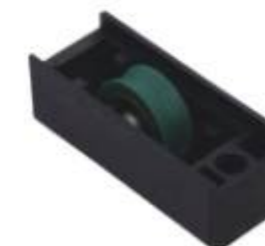

SLIDING WINDOW ROLLER
LOAD CAPACITY: 20KG

SR 14

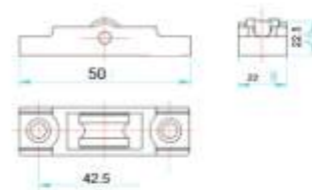

SLIDING WINDOW ROLLER
LOAD CAPACITY: 50KG

SR 06

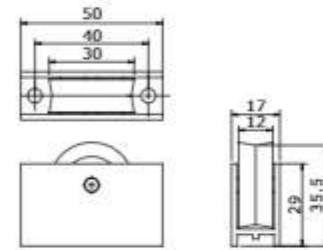

SLIDING DOUBLE WHEEL ADJUSTABLE ROLLER
(29/32MM SERIES)

SR 62

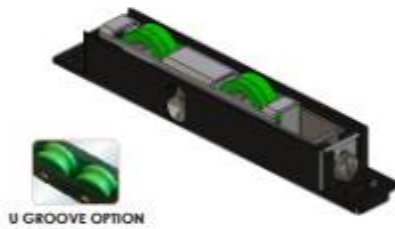

U GROOVE OPTION

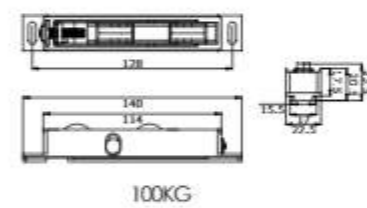

100KG

SLIDING DOUBLE WHEEL ADJUSTABLE ROLLER

SR 44

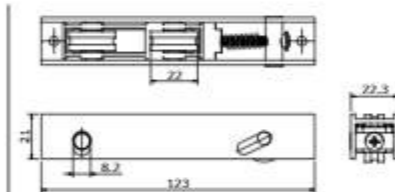

120KG

SLIDING SINGLE WHEEL ADJUSTABLE ROLLER
(37MM SERIES)

SR 45



U groove option

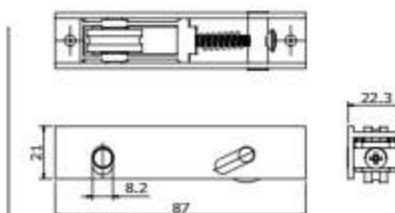

60KG

SLIDING DOUBLE WHEEL ROLLER
LOAD CAPACITY: 80KG
(35MM SERIES)

SR 46

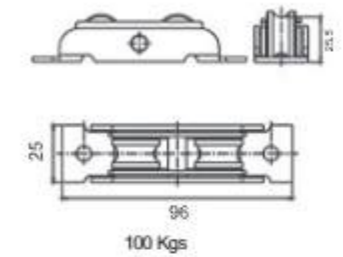

100 Kgs

SLIDING DOUBLE WHEEL ADJUSTABLE ROLLER
LOAD CAPACITY: 175KG
(37MM SERIES)

SR 42

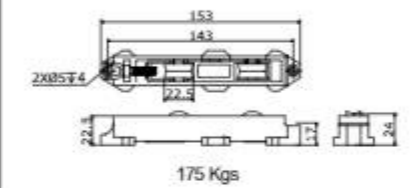

175 Kgs

SLIDING DOUBLE WHEEL ADJUSTABLE ROLLER
LOAD CAPACITY: 120KG
(35MM SERIES)

SR 48

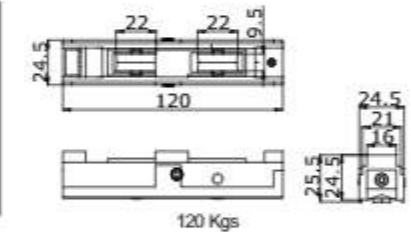

120 Kgs

ADJUSTABLE DOUBLE WHEEL NYLON DOOR ROLLER

SR 24

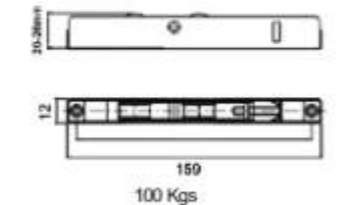

100 Kgs

ADJUSTABLE DOUBLE WHEEL NYLON DOOR ROLLER

SR 52

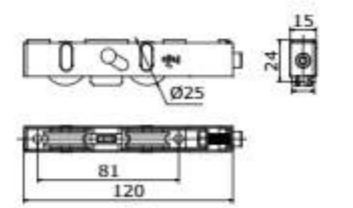

100 Kgs

ADJUSTABLE FOUR WHEEL
NYLON DOOR ROLLER
(27/29 MM SERIES)

SR 53



240 Kgs

ADJUSTABLE DOUBLE
WHEEL NYLON DOOR ROLLER
(35/37 MM SERIES)

SR 54



120 Kgs

ADJUSTABLE FOUR WHEEL
NYLON DOOR ROLLER
(35/37 MM SERIES)

SR 55



300 Kgs

ADJUSTABLE DOUBLE
WHEEL NYLON
DOOR ROLLER

SR 56

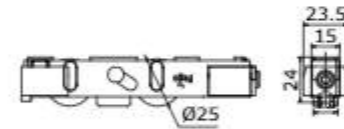

100 Kgs

ADJUSTABLE FOUR WHEEL
NYLON DOOR ROLLER

SR 57

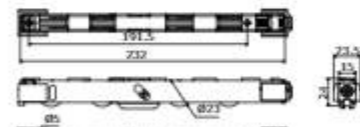

240 Kgs

ADJUSTABLE FOUR WHEEL
NYLON DOOR ROLLER

SR 59

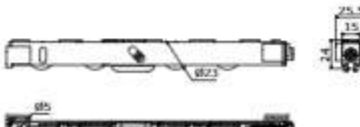

100 Kgs

SINGLE WHEEL
ADJUSTABLE ROLLER

SR 71

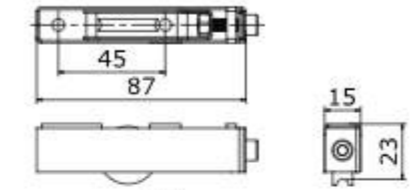

50 Kgs

ADJUSTABLE DOUBLE
WHEEL NYLON
DOOR ROLLER

SR 72

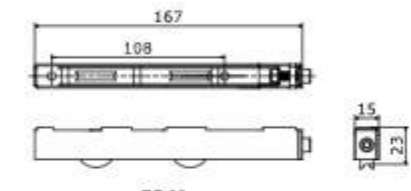

80 Kgs

ADJUSTABLE FOUR WHEEL
NYLON DOOR ROLLER
(27/29 MM SERIES)

SR 73

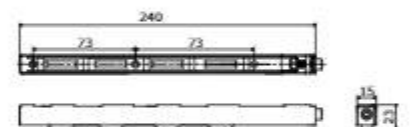

120 Kgs

SINGLE WHEEL
ADJUSTABLE ROLLER

SR 74

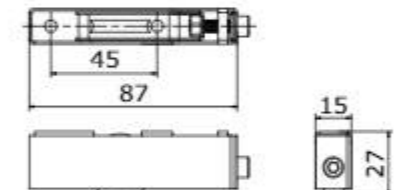

55 Kgs

ADJUSTABLE DOUBLE
WHEEL NYLON
DOOR ROLLER

SR 75

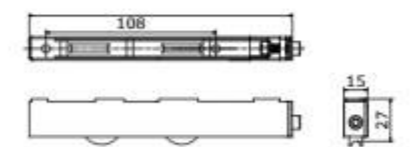
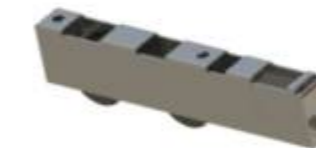

90 Kgs

ADJUSTABLE FOUR WHEEL
NYLON DOOR ROLLER
(27/29 MM SERIES)

SR 76

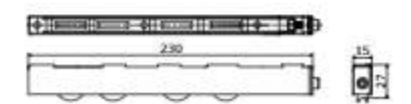

150 Kgs

ADJUSTABLE DOUBLE
WHEEL NYLON
DOOR ROLLER

SR 77

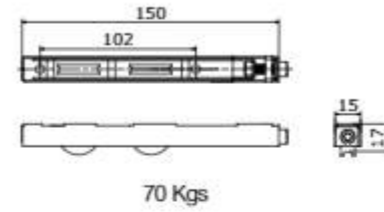

ADJUSTABLE FOUR WHEEL
NYLON DOOR ROLLER

SR 78

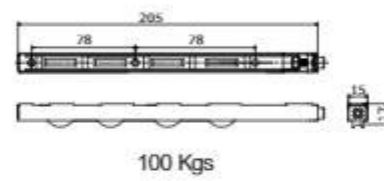

ADJUSTABLE DOUBLE
WHEEL NYLON
DOOR ROLLER

SR 79

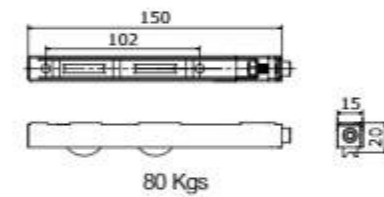

ADJUSTABLE FOUR WHEEL
NYLON DOOR ROLLER

SR 80

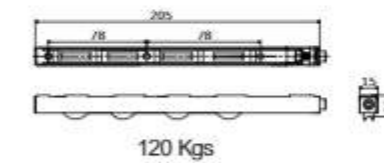

ADJUSTABLE DOUBLE
WHEEL NYLON
DOOR ROLLER

SR 81

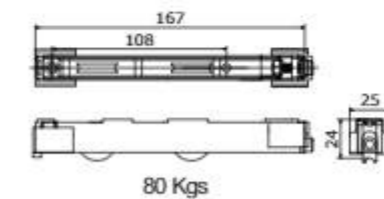

ADJUSTABLE FOUR WHEEL
NYLON DOOR ROLLER

SR 82

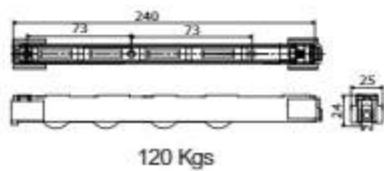

SINGLE WHEEL
NYLON ROLLER

SR 21PVC

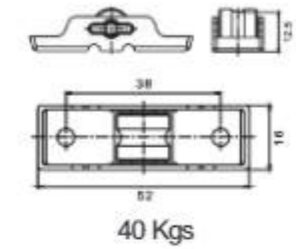

DOUBLE WHEEL NYLON
SWING ROLLER

SR 23PVC

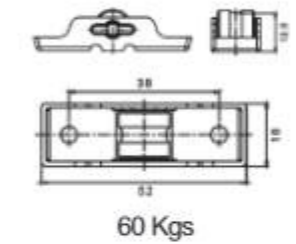

SLIDING
'V' DOOR ROLLER

SR 04

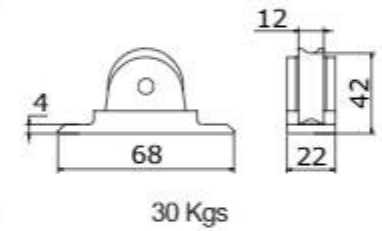

SINGLE WHEEL
DOOR ROLLER

SR 04-30

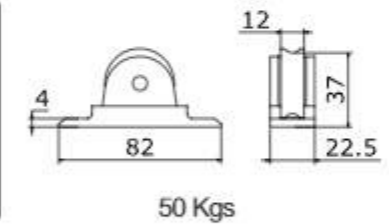

SLIDING METAL
BODY ROLLER

SR 16



SLIDING METAL
BODY ROLLER

SR 16S



CASEMENT DOOR LOCKS



CASEMENT DOOR LOCKS

MULTIPOINT MORTISE
LOCK BODY
(BACSET 25MM)

MLK 85*25

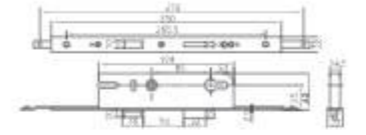

MULTIPOINT MORTISE
LOCK BODY
(BACSET 30MM)

MLK 85*30

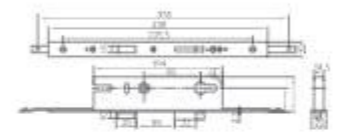

MULTIPOINT MORTISE
LOCK BODY
(BACSET 35MM)

MLK 85*35

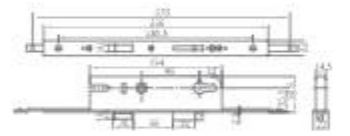

MULTIPOINT
HOOKBOLT
DOOR GEAR 85*35

MLK-HKB

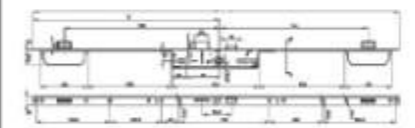

MORTICE LOCK
(85X20 MM)

LK 01 85*20

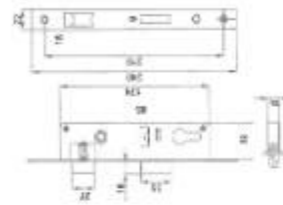

MORTICE LOCK
(85X25 MM)

LK 01 85*25

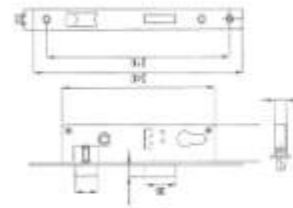

MORTICE LOCK
(85X30 MM)

LK 04

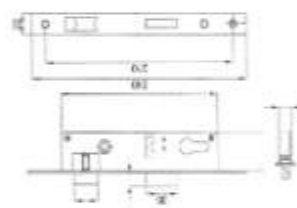

MORTICE LOCK
(85X35 MM)

LK 05

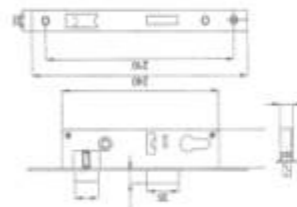

CYLINDRICAL
DEADLOCK 38MM

LK 02

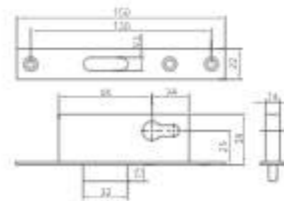

CP 01

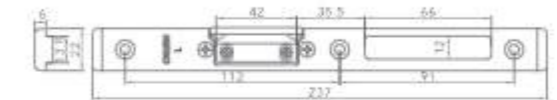

CP 02

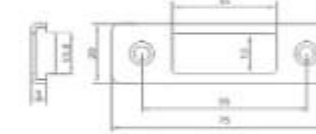

CP 03

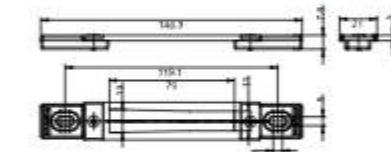

CP 04

TOP & SIDE HUNG CASEMENT SYSTEM

TECHNICAL SPECIFICATIONS:

- Maximum Sash Width: 800mm
- Maximum Sash Height: 1400mm
- Maximum Sash Weight: 50 kgs





TILT & TURN SYSTEM

TECHNICAL SPECIFICATIONS:

- Gearbox Backset: 10mm
- Maximum Shutter Weight: 80Kgs
- Maximum Shutter Height: 1800mm
- Concealed Stays Application

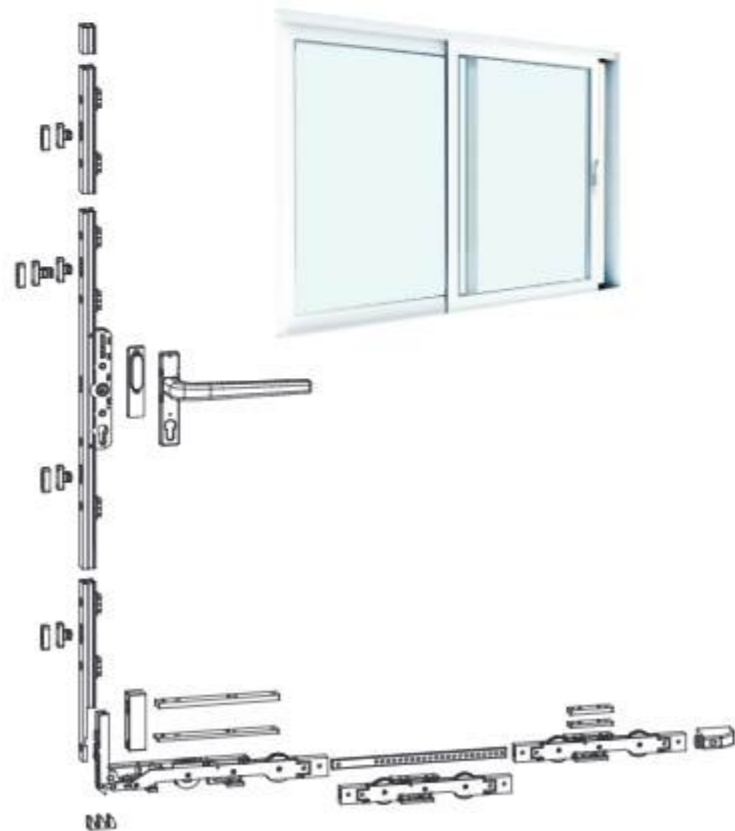

LIFT & SLIDE HARDWARE

TECHNICAL SPECIFICATIONS:

- Axis: 37.5mm
- Sash Width: 900-2200mm
- Sash Height: 2100-3200mm
- Maximum Sash Weight: 400 kgs

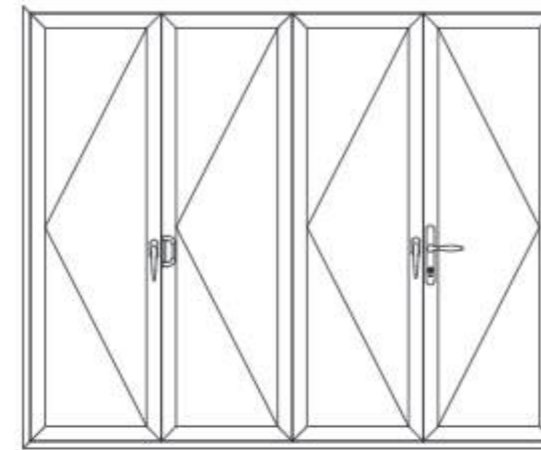

SLIDING FOLDING SYSTEM

TECHNICAL SPECIFICATIONS:

- Maximum Sash Width: 900mm
- Maximum Sash Height: 3000mm
- Maximum Sash Weight: 85 kgs
- Low Thresh Hold Option Also Available

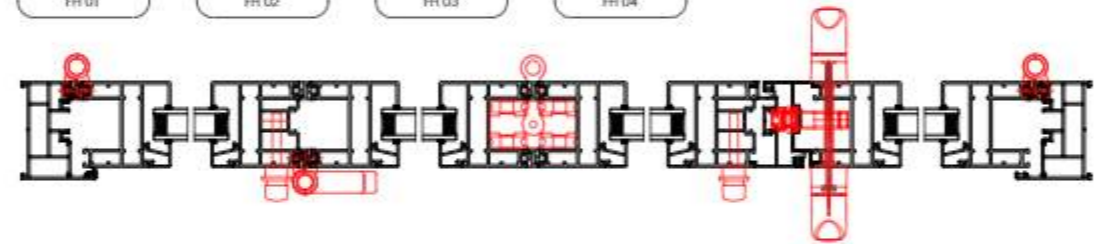

HANDLE OPERATED ARM STAY

TECHNICAL SPECIFICATIONS:

- Sash Width: 350-1150mm
- Maximum Sash Weight: 150 kgs
- T Connector & Gearbox options possible



DOOR HANDLES



DOOR HANDLES

MORTICE HANDLE

HD 21

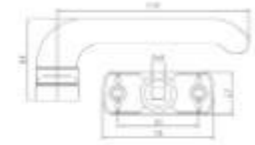

MORTICE HANDLE

HD 25

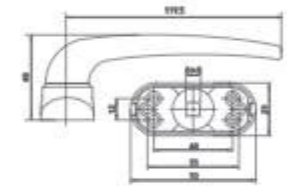

MORTICE HANDLE

HD 27

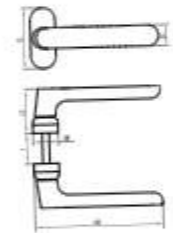

CASEMENT
DOOR HANDLE

HD 22T

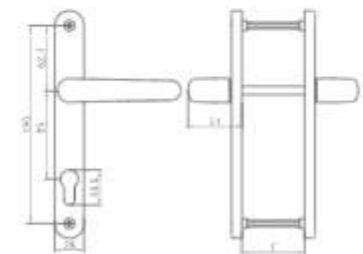

CASEMENT
DOOR HANDLE

HD 22P

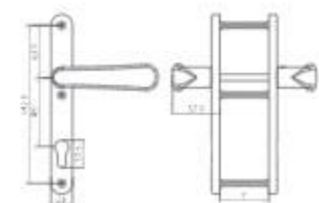

CASEMENT
DOOR HANDLE

HD 22-AS

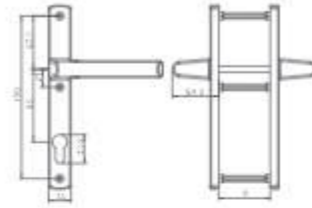

CASEMENT
DOOR HANDLE

HD 29

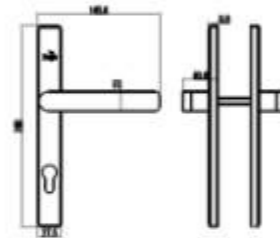

CASEMENT
DOOR HANDLE

HD 111

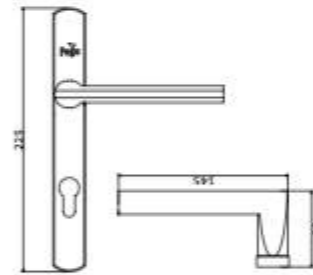

CASEMENT
DOOR HANDLE

CAP 21

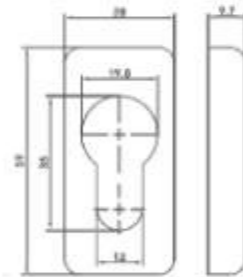

CASEMENT
DOOR HANDLE

CAP 25

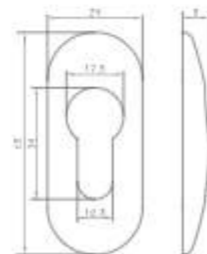

BUMP STOPPER

DS 11

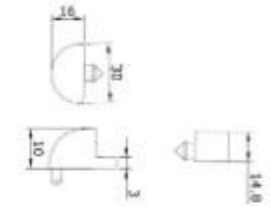

BUMP STOPPER

DS 12

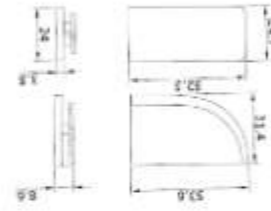

BUMP STOPPER

DS 13

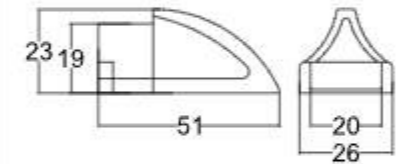

TOILET LOUVERS

TL 01



Blades	Length (mm)
3	290
4	280
5	470
6	560

CYLINDER WITH
ULTRA KEYS

CY

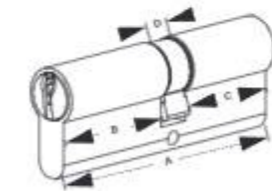

Product Code	A	B	C	D
CY 60	60	25	25	10
CY 70	70	30	30	10
CY 70S	70	35	25	10
CY 80	80	35	35	10
CY 85S	85	50	25	10
CY 90	90	40	40	10

HINGES



EURO HINGE

BH 01

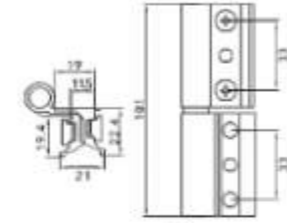

60kgs

EURO HINGE

BH 01-ALP

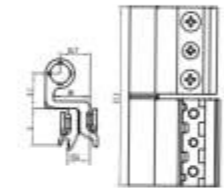

60kgs

EURO HINGE
(40MM SERIES)

BH 02

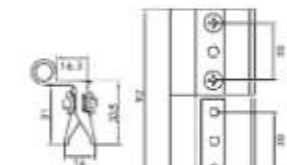

60kgs

EURO HINGE
(52MM SERIES)

BH 05

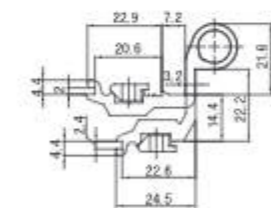

60kgs

CENTER
SUPPORT HINGE

BH 07

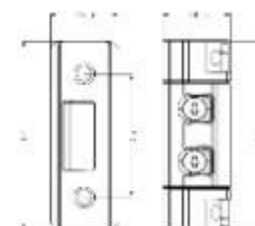

EURO
BRIDGE HINGE

BH 08

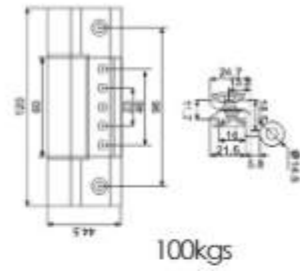

EURO DOOR HINGE
(WEIGHT CAPACITY: 1
50KGS)

BH 06

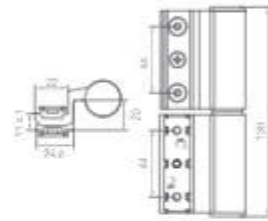

HEAVY DUTY
EURO HINGE

BH 09

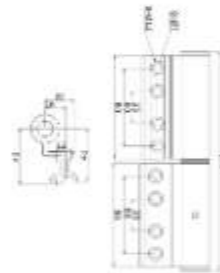

CONCEALED
DOOR HINGE

BH 51

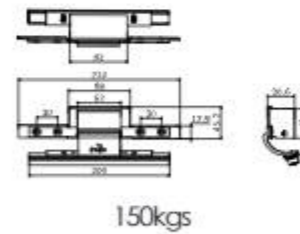

SASH WING CONNECTOR

MS 01



ANTICAPILLARY PAD

MS 02



SASH STOPPER

MS 03



ANTI LIFT

MS 04



ANTI LIFT HANDLE

MS 05



SLIDING STOPPER

MS 06



INTERLOCK CAP

MS 07



MS 08



ANTI RETLING GUIDE

MS 09



U PACKER

MS 10



GLASS PACKER

MS 11



FASTENER CAP

MS 12



SASH TOPER

MS 13



5x6, 6x6 &
6.8x6, 6x7

WOOLPILE