

# ACR series



ACR-N B63-S100

### Features

- Aluminium tube
- Shortened round cylinder
- Lighter weight than that of conventional type

### Symbol

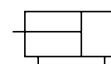

Double Acting /  
Single Rod

## How to Order

ACR - N B 63 - S 100

①      ②      ③      ④      ⑤

### ① Series

ACR	Round cylinder
ACRK	Round cylinder(Rod rotation prevention type)

※ Only Ø50 and Ø63 of rod rotation prevention type are manufactured.

### ② Lubrication

N	Non-lubricated type (Standard)
---	--------------------------------

### ③ Mounting style

B	Standard
---	----------

### ④ Bore size

50	63	80	100
Ø50	Ø63	Ø80	Ø100

### ⑤ Cylinder stroke (mm)

25, 50, 75, 100, 125, 150, 200, 250, 300
--

## Specifications

Cylinder Bore size	Ø50, Ø63, Ø80, Ø100
Fluid	Air
Proof pressure	14.7kgf/cm <sup>2</sup> (1.5MPa)
Max. operating pressure	9.9kgf/cm <sup>2</sup> (1.0MPa)
Min. operating pressure	0.5kgf/cm <sup>2</sup> (0.05MPa)
Ambient & fluid temperature	Without auto switch : -10°C ~ 70°C(Without freezing) With auto switch : -10°C ~ 60°C(Without freezing)
Operating piston speed	50~500mm/sec
Cushion	Air cushion
Tolerance of thread	KS Class 2
Tolerance of stroke	~ 1000 <sup>ST</sup> : $\begin{matrix} +1.4 \\ 0 \end{matrix}$ , ~ 1500 <sup>ST</sup> : $\begin{matrix} +1.8 \\ 0 \end{matrix}$
Type	Non lubricated
Degree of non-rotating load	±0.5°
Allowable rotation torque(N·m Below)	0.44

## Precautions for installation

1. When using the rod anti-rotation cylinder, avoid using the piston rod with rotational torque. The non-rotating guide is deformed and the degree of non-rotation increases.
2. When mounting or dismounting the work piece at the end of the rod, hold the spanner at the end of the piston rod with the piston rod fully retracted before use. At this time, tighten so that the tightening torque is not applied to the anti-rotation guide.

Dimensions-Standard (B)

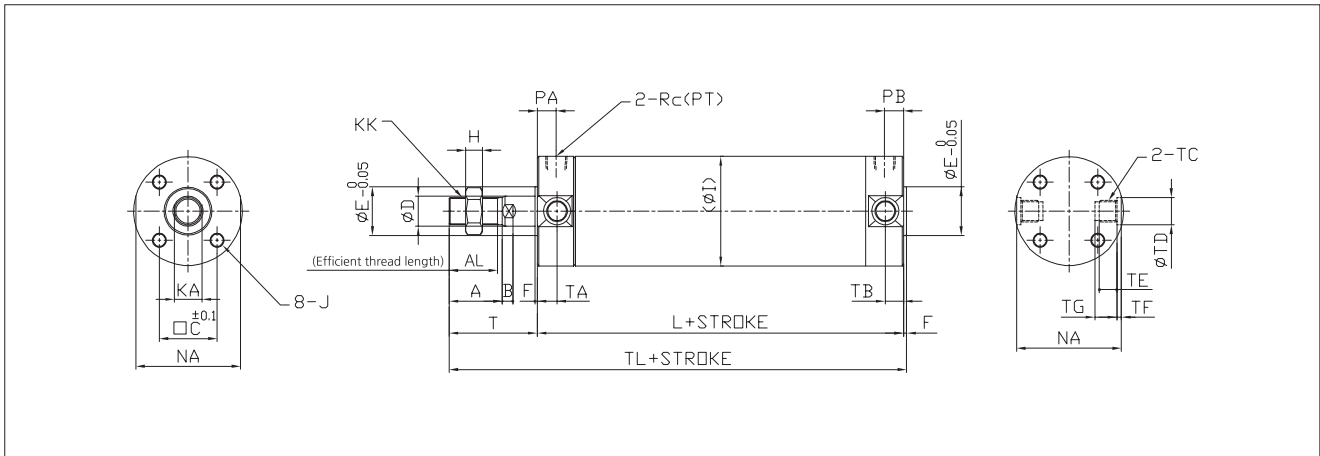

Unit : mm

Bore size	Standard stroke range	Long stroke range	A	AL	B	C	D	E	F	H	I	J	KA	KK	L	NA
Ø50	~300	301~1200	35	32	7	32	20	30	2	11	56	M8XP1.25 Depth16	18	M18XP1.5	102	55
Ø63	~300	301~1200	35	32	7	38	20	32	2	11	69	M10XP1.5 Depth16	18	M18XP1.5	102	69
Ø80	~300	301~1400	40	37	10	50	25	40	3	13	87	M10XP1.5 Depth22	22	M22XP1.5	122	80
Ø100	~300	301~1500	40	37	10	60	30	50	3	16	108	M12XP1.75 Depth22	27	M26XP1.5	122	100

Bore size	PA	PB	Rc(PT)	T	TA	TB	TL	TC	TDH9	TE	TG
Ø50	14	12	1/4	58	-	-	162	-	-	-	-
Ø63	14	12	1/4	58	13	12	162	M14XP1.5	18 <sup>+0.08</sup> <sub>0</sub>	11.5	14.5
Ø80	20	16	3/8	71	-	-	196	-	-	-	-
Ø100	20	16	1/2	71	-	-	196	-	-	-	-