



MEJOR CASA BROCHURE

www.Bighomesnigeria.com

What if you could have all your expectations for a luxury dream home met and exceeded? Mejor Casa is a luxury semi-detached duplex from Big homes that promises space, views and good natural ventilation with a feeling of homeliness.

BigHomes

INTRODUCTION



Mejor Casa is a luxury semi-detached duplex with an array of meticulously planned personal spaces that are designed to give occupants a feel of luxury and homeliness.

Mejor Casa sits on 2500sqm of land in Asokoro, which houses the two units of semi-detached luxury duplexes that both have four bedrooms, with four units of self-contained apartments, all of which are carefully laid out on the plot in Asokoro.

This property exudes a peaceful ambiance which allows the owners of each unit to reflect their individual lifestyles.

This estate comes fully serviced with an automated and guarded entrance, 24/7 electricity supply, armed security personnel and gardeners to make sure the greenery on site is always cared for.

CONTENT

Table Of Content	03
Site Plan	04
Floor Plans	05
Living / Dinning Area	08
Master's Bedroom	10
Master's Bathroom	12
Exterior	13



SITE PLAN

THE FUNCTIONS ON THE SITE ARE CAREFULLY LAID OUT;

- 1 - Access Road
- 2 - Access Gates
- 3 - Gate House
- 4 - Main Building's Parking
- 5 - Main Building
- 6 - Walkway
- 7 - Sit-out
- 8 - Gen House
- 9 - BQ Car Park
- 10 - BQ
- 11 - Walkway

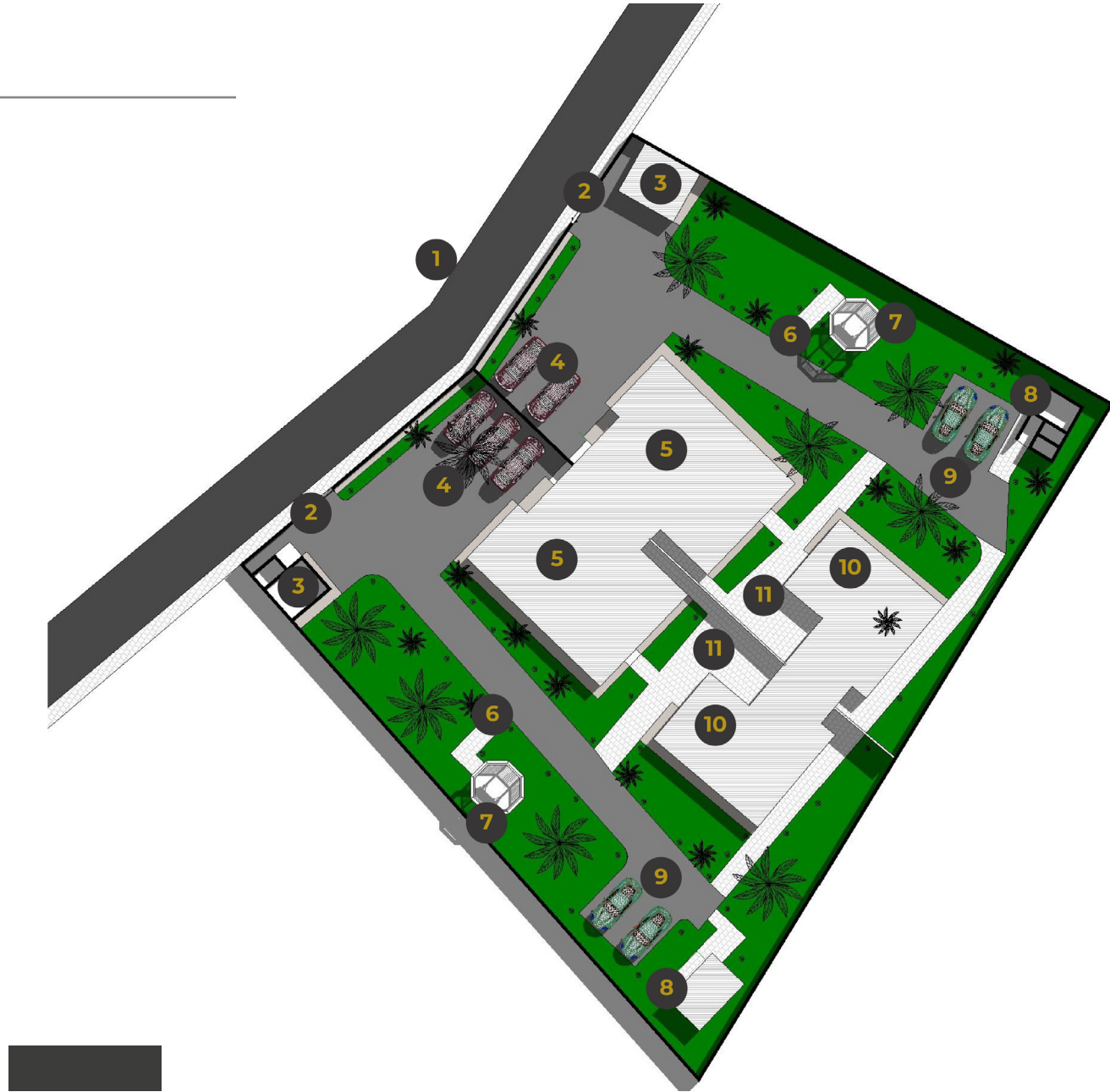

GROUND FLOOR PLAN

THE IMAGE TO THE RIGHT SHOWS THE LAYOUT OF THE GROUND FLOOR PLAN;

- Ante Room
- Living Room
- Dining Area
- Kitchen
- Main Entrance



FIRST FLOOR PLAN

THE IMAGE TO THE RIGHT SHOWS THE LAYOUT OF THE FIRST FLOOR PLAN

- 4 Bedrooms(Right Unit)
- 3 Bedrooms (Left Unit)
- BQ Attached (Left Unit)
- Family Lounge (Left Unit)
- 4 Bathrooms (Right Unit)
- 3 Bathrooms (Left Unit)



3D EXTERIOR



LIVING/DINING AREA

The living and dining setting of Mejor Casa is designed with luxury in mind and features an open plan design style, which allows for improved ventilation and lighting. The living and dinning areas like the rest of the house feature large window areas that allow for cross ventilation and ample lighting conditions.



MASTER'S BEDROOM

The master's bedroom is spacious and designed to take advantage of the view across the site, there is a big glass door that leads to a balcony where the occupant can enjoy the view or just relax.

The masters bedroom also like most of the other parts of the house has very little need for artificial ventilation as there is ample ventilation owing to the large sliding glass door as well as the two other windows on the adjacent side of the room. There is however provision for AC units should one feel the need to cool the room artificially.





MEJOR CASA EXTERIOR



CALL US FOR MORE INFO

+2348167924660 • +2348084580607

Www.bighomesnigeria.com

Bighomesoffice@gmail.com

Plot 903 Valentine Nwabueze Crescent Jahi District, Abuja

