

**KEYS**

- 1 Timber framing 2 Wall underlay meeting requirements of E2/A21
- 3 Cavity battens
- 4 Air gap
- 5 StoPoren Panel
- 6 StoPoren render system
  - S protect WS 205 sealer
  - Poren render
  - Mesh reinforcement render
  - Stoplex w. sealer
  - Stolit Milano finishing render
- 7 Interior lining
- 8 Airseal on pef rod gap 8mm approx
- 9 Flashing tape onto wall underlay with 15" slope
- 10 Aluminium window flashing with 15" slope
- 11 Aluminium window joinery
- 12 Cat 'window' shelf 250x500mm

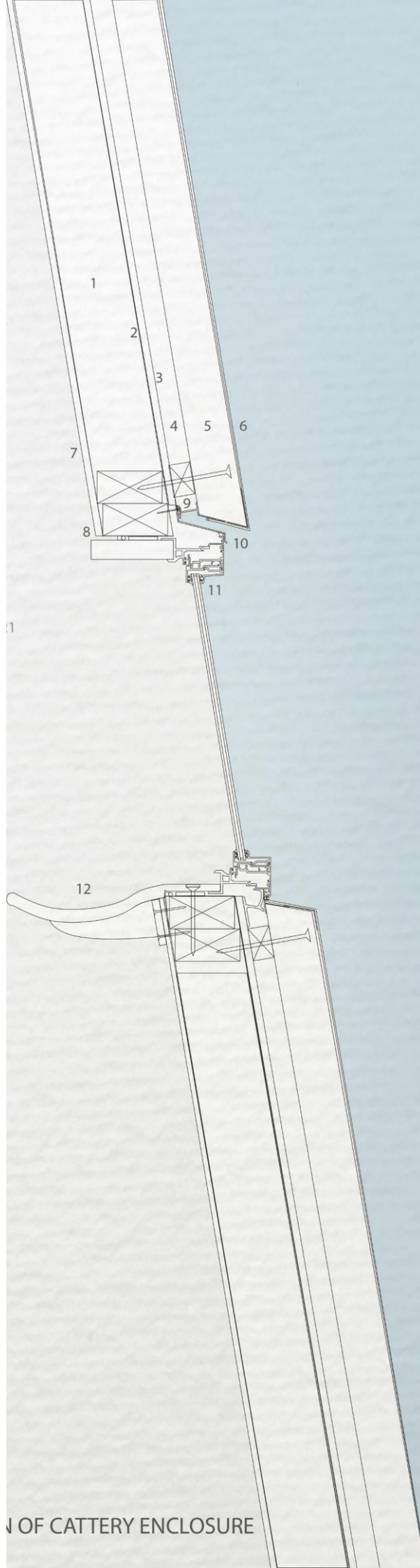

**WALL TO WINDOW  
JUNCTION OF CATTERY  
ENCLOSURE**









SITE PLAN 1:500

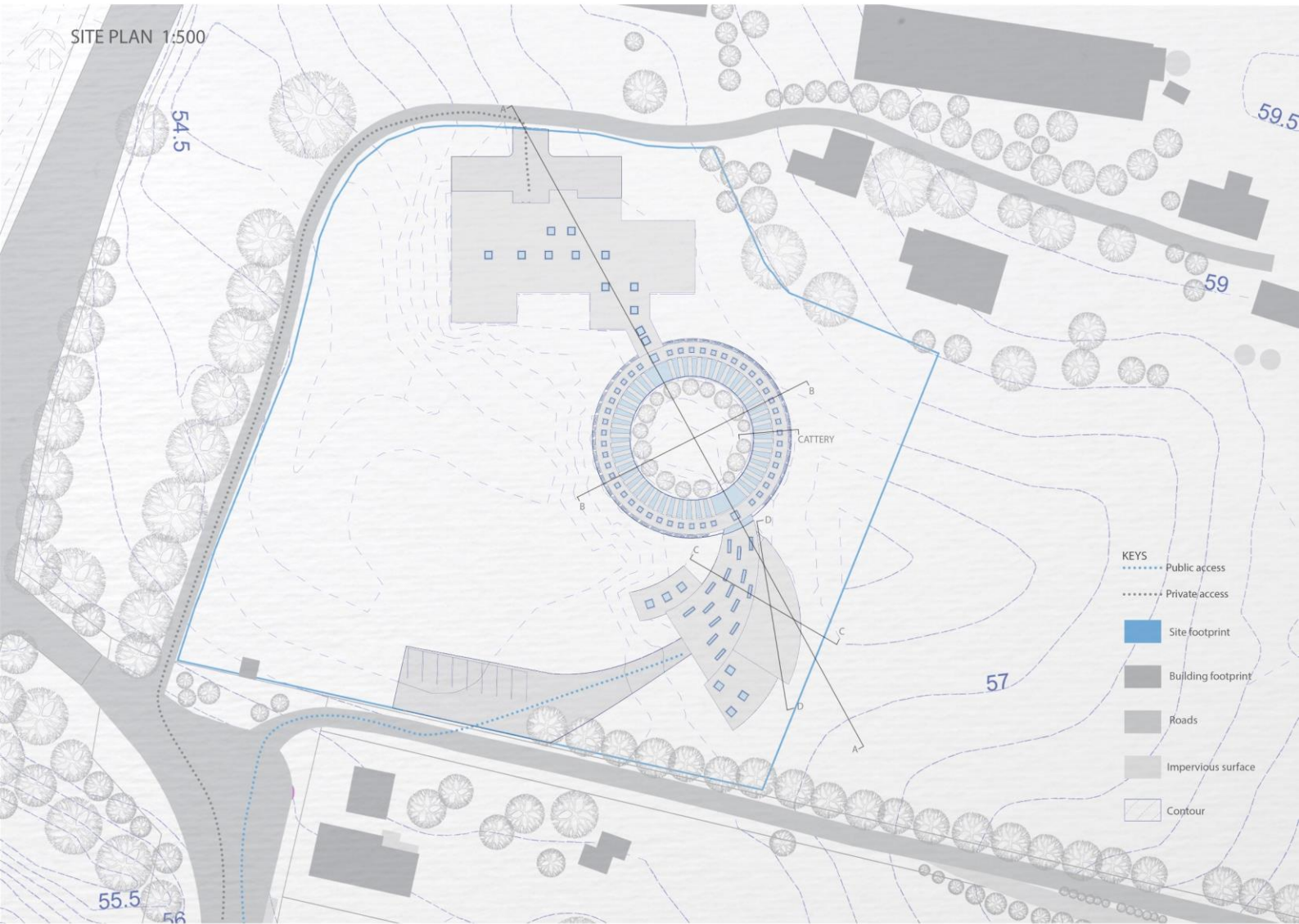

- KEYS
- Public access
  - Private access
  - Site footprint
  - Building footprint
  - Roads
  - Impervious surface
  - Contour

# ZONING ORGANISATION DIAGRAM



Client : Lonely Miaow Association Incorporated  
 Proposal : Cat rescue centre at 47 Township Road, Waitakere, New Zealand  
 Capacity : 300-400 cats and kittens

1 00 adopted per week  
 30 euthanised per week

This project aims to increase the amount of cats and kittens adopted, by creating an interesting experience for potential adopters. To create an experience area to put visitors through a similar experience the cats may have experienced prior to being rescued in hope to evoke empathy and also raise awareness. While also acknowledging the strict hygiene requirements needed to prevent spread of disease.

Standardised clinical functions

Operations that wouldn't be appropriate for the general public to see

Set on opposite public zoning end of being from

-Building where majority of cats would

-Prioritising cats comfort in order to reduce their stress during their stay -'Funneling' people into the building

- Experience space for evoke empathy and experience what a stray cat may have been through, prior to rescue.

Cat tunnel

One way window  
Looking in to out

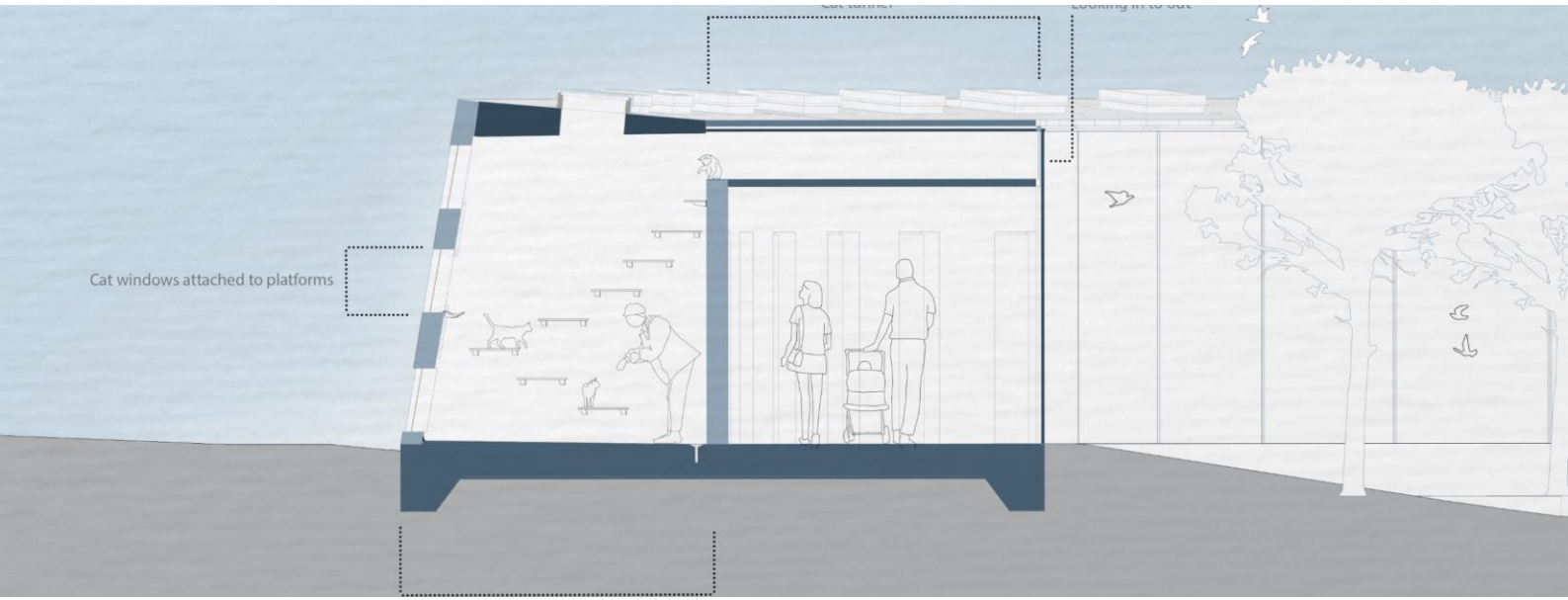

## SECTION CATTERY

